

雅思分手指南系列

听力篇



考虫出品

龙腾教育微信号; LTJY28888

龙腾教育微信号; LTJY28888

龙腾教育微信号; LTJY28888

前言

PREFACE

一、《分手指南》= 历年真题回忆集锦

雅思考试初期，题量有限，每次考试中都会循环使用到之前考试出现过的“旧题”。当时的考生的考生发现了这条的规律，于是就利用网络将这些“旧题”回忆成没有音频的题集，用于备考复习。

近些年雅思官方不断在扩充题库，但至今考试依然是“新 / 旧题”混搭的模式。这也意味着，分手指南还是大家必不可少的备考资源。

本次《分手指南》中共收纳到了 289 篇考试回忆。经过 30 年的反复回忆，它们中间的多篇题都和真实考试题目极其相似了。

二、使用方法：阅读 + 背诵

首先，建议同学们阅读每篇考试回忆的话题。通过阅读，大家可以熟悉考试涉猎的话题领域，了解每一个话题的出题规律。比如，在邮寄和保险的话题下，经常会出现对订单号的询问。自己总结一下订单号的形式将有助于自己在未来练习听力的过程中快速且准确的预测答案信息。

当然，在阅读的过程中，我们会遇到一些不熟悉 / 不理解的单词。我们需要将它们标记且整理到笔记上。务必将这单词牢记（发音 / 拼写 / 含义），因为它们一定还会出现在未来的练习 / 考试中。

* 备注：本书只对试卷题目信息进行了回忆整理，并不包含原文内容。

三、实用性：还原真实的国外生活

我的一名学生，留学英国 6 个月之后，在微信上给我留言：“老师，雅思听力考试的内容在国外好实用”。她所说的“内容”指的是考试的话题。雅思考试的听力材料取材于真实的国外生活，目的是为了让“烤鸭们”透过考试对未来有所准备。为了方便记忆，在编写《分手指南》的过程中，我将真题回忆按照话题内容进行了分类。希望这本书不仅能帮助大家通过开始，还能帮助大家了解未知的国外学习和生活场景。

笑颜 Grace

龙腾教育微信号；LTJY2008

目录

CONTENTS

Section 1: 咨询, 2人对话

报名/注册.....	3
休闲娱乐.....	17
工作.....	27
租/住.....	32
日常生活.....	40
保险.....	47
搬运/邮寄.....	50

Section 2: 介绍, 1人陈述

生活资讯.....	55
工作信息.....	64
课程信息.....	70
运动信息.....	76
综合信息.....	82

Section 3: 讨论, 2-4人对话

课程选择.....	89
作业讨论.....	107

工学专业 (建筑,交通,能源,生产)	122
管理类专业	130
教育学专业	136
理学专业 (生物,地理,环境,计算机)	141
心理学专业	145
文/艺专业 (文学,艺术)	149
实习反馈	152

Section 4: 讲座, 1人陈述

动物研究	159
文化研究	168
教育研究	178
环境研究	183
科技研究	187
社会研究	191
健康研究	195
商业研究	200
植物研究	202
建筑研究	205

Section

1

龙腾教育微信号 LTJY28888

龙腾教育微信号; LTJY28888

报名 / 注册

例题 1	航海俱乐部	填空 10
------	-------	-------

1-5 填空

- will be open late on nights of Thursday/Wednesday until 11 p.m.
- annual membership fee: \$138 a family with a child age under 16
- address of club: in the Lossley Road
- the keys will be given at the side gate
- good facilities in the café (provide free coffee, barbecue and balcony)

6-10 表格填空

Course Name	Price	Something to Bring
Beginner's course	***	in a 6. <u>sleeping bag</u>
Teenager's swimming	***	
7. <u>wind surfing</u> course	***	
Dolphin Watch	***	need to bring 8. <u>passport</u>
Advantage in sea	***	9. <u>radio</u>
contact telephone number: 10. <u>0730****5552</u>		

例题 2	跑步俱乐部	填空 10
------	-------	-------

- trainer's name: Mark Crichton

Sport Item	Length	Time	Location
sprinters	100 meters	***	2. <u>sport center</u>
middle range distance	3. <u>800</u> meters' run	4. <u>6.15</u>	
2. long road runner	10 kilometers	6. <u>Thursday</u>	7. <u>North Park</u>

8. recommended to buy: a club vest (such as sweater or a special shoes)
 9. Next competition is going to be on the month of July
 10. contact phone number 07958477222

例题 3	音乐课	单选 3+ 搭配 3+ 填空 4
------	-----	------------------

1-3 单选

1. What the teacher praise student Emma for:

A good performance in public show

B set example for others

C get start quickly

2. Why did the course need to change the time?

A falling enrollment (enrolment is too much)

B size of the classroom (注册的人太多了, 地方 space room limited 不够大了)

C availability of music room (music room is not available)

3. when does the new class begin ?

A 3.15 p.m.

B 4.15 p.m.

C 4.45 p.m.

4-6 搭配

What is the reason that Emma cannot have the course?

A the course is full

B the course fee is too expensive

C she has another activity at that time

D she has another activity at that evening

4. dance class — **A** (I have to put you in the waiting list.)

5. singing class — **D** (Emma has drama class on Friday evenings, it is too late in the evening 晚上回家会很晚了)

6. vocal class — **B** (老师说 Emma 歌喉很好, 但是那个男的说太贵了)

7-10 填空

7. teach children to play instruments and to write music (compose music, at last, performance music, having lot of fun)

8. course fee: \$ 85 (包括多加的 22 元)

9. Emma can start at : **14th September** (原文 7th Sep 干扰, 因为女的说这是该课程 的开始时间, 父亲就

说 Emma 有特殊情况, 所以只能在 14th Sep 才能开始。)

10. teacher's name: Jamal Curtis

例题 4	志愿者	填空 10
------	-----	-------

1. address: 62 Mileda Street
2. language skill: French and Chinese
3. bring old to shopping
4. know how to socialize with people
5. license to drive
6. where does she live now ? South of the river
7. be free only on Wednesday
8. date to start: 13th June
9. put the mail on to the stairs in front of the house
10. get the information on the radio

例题 5	独木舟培训课程	填空 10
------	---------	-------

1. 50
2. 70
3. rules
4. helmet
5. race
6. towel
7. clothes
8. insurance
9. ***
10. 5th

例题 6	烹饪比赛	分类 5+ 填空 5
------	------	------------

- 1-5 分类
- A Thai Cookery
- B Italian Cookery
- C French Cookery

D All Three

1. Full registration for — B
2. Available in the evening — D
3. Beginners 可以学 — A
4. Have a discount for... — C
5. Tutor from the same country — C

6-10 填空

6. His name: Furness
7. Date: 16th October 1987
8. Address: River Avenue
9. How to contact: leave a message
10. Pay by: cash

例题 7	健身房	填空 2+ 单选 2+ 搭配 6
------	-----	------------------

1-2 填空

1. date of birth: August 24, 1979
2. address: Fox Lane

3-4 单选

3. What's the reason for the woman choose yearly payment

A to save money

B to get free gift

C to get fitter

4. schedule for June

A holiday

B business trips

C getting married

5-10 搭配

A She will be interested in it in the future

B She is interested in it now

C She is not interested in it at all

5. fitness class — C

6. weight class — B

7. class in the pool — C

- 8. swimming — A
- 9. sauna — B
- 10. child-minding — A

例题 8	夏令营	搭配 4+ 填空 6
------	-----	------------

Day One

- 1. Try climbing for the first time
- 2. the students can pay to borrow shoes during the camp(原文用 hire 替换 pay to borrow)
- 3. lunch will be barbecue or pizza (if weather is good, make BBQ, if it's not, then pizza)
- 4. students can enjoy spectacular view of the city

Day Two

- 5. students can try football game
- 6. in the afternoon, they will watch dancing from aborigines
- 7. students live in a block named Paige
- 8. when the camps are full, it can contain 95 students
- 9. the price is 150 pounds per student
- 10. it does not include transport

例题 9	体育摄影课程	填空 10
------	--------	-------

1-6 填空

The course is suitable for 1. beginner

No need for 2. interview

Cost for student 3. 38

The course begins from 4. April 17

Telephone:5. 01739587302

Students need to bring two different types of photos of different 6. weather

7-10 表格填空

Saturday	morning	<ul style="list-style-type: none"> · introduction · how to choose 7. <u>equipment</u>
	afternoon	discuss the 8. <u>position</u> to take photos
Sunday	***	<ul style="list-style-type: none"> · workshop of how to 9. <u>edit</u> pictures · advice on how to 10. <u>sell</u> them

例题 10	瑜伽课程	填空 10
-------	------	-------

Yoga Booking

1. course starting date: June 27
 2. customer's address: Swavesey
 3. course level: intermediate
 4. total payment: 285
- morning yoga session: 30 minutes of 5. relaxation
 food covered: 6. vegetarian food
 other activities: walking
7. swimming
 8. horse riding (book in advance)
 9. tennis (free)
- yoga session: held 10. outside

例题 11	爬山课程咨询	填空 10
-------	--------	-------

Course	About	When	Duration	Cost
Taster Sessions	to learn the basic 1. <u>safety</u>	on 2. <u>Tuesday</u> evening	each session lasts one 3. <u>hour</u>	18
Group Sesions	to learn to work together	***	***	4. <u>12</u>
Stage2:Climbing Course	to learn climbing with any 5. <u>supervision</u>	on 6. <u>Thursday</u> evening	one	75 for adults
Stage 3:*** Course	to learn climbing on the 7. <u>rock</u>	throughout the 8. <u>summer</u>	one 9. <u>month</u>	140(does not include 10. <u>transport</u>)

例题 12	游泳馆	填空 10
-------	-----	-------

Swimming Pool

	Suitable Customers	Facilities Available	Good Points	Bad Points
Burnside Pool	1. <u>young children</u>	a 2. <u>cafe</u>	life guards	parking place is hard to find
City Bath	entry level	vending machine	excellent 3. <u>changing room</u>	4. <u>timetable</u> is hard to follow
Mariners Pool	5. <u>learners</u>		free 6. <u>lock</u> for clothes cabinet	get very 7. <u>crowded</u>

Trains for 11-13s

8. 3 times a week

9. starts at 5:30 p.m.

10. transport lost approx. \$30

例题 13	游泳课程	填空 10
-------	------	-------

Example: swimming toys for babies

1. Introduce breathing techniques in water

2. focus on the safety

3. improving the diving

4. intermediate level course are for adults

5. 课程开始时间: January 13

6. each learner should bring a towel

7. aim to improve speed

8. bring change to rent locker

9. required to swim with a hat

10. improve the confidence

例题 14	游泳课程	填空 10
-------	------	-------

1. discount price 26.65 per day.

2. 当天具体什么活动取决于 depend on the weather

3. ticket not including the lunch
4. 额外带的东西 clothes, such as trousers, jacket
5. Location : beside the lakes

Activities information details

Activities	***	***
6. <u>climbing</u>	towers	***
7. <u>mountain</u> hike	***	不能使用 8. <u>long stick</u>
riding motor	beach	organization will provide a 9. <u>helmet</u>
***	***	10. <u>race</u> is not allowed

例题 15	国际俱乐部	填空 10
-------	-------	-------

1. 8.50
2. main
3. top
4. swimming pool
5. carnival
6. partner
7. annual fee: 30
- Activity event
8. dance
9. ***
10. ***

例题 16	新生入学登记	填空 6+ 单选 4
-------	--------	------------

- 1-6 填空
1. The Nationality Of the girl Sarah is: Australian
 2. Address: No. 65 Park Road
 3. Phone: 027-*****
 4. Emergency contacts: Mr Thompson is Sarah's relative, relationship: Sarah's grandfather
 5. Allergy to: nuts
 6. She has achieved good results in reading at HongKong School.

7-10 单选

7. At present, the total number of students

A 480

B 502

C 560

8. Average students number (size) of each class

A 24

B 26

C 27

9. What causes more challenging,

A Cantonese

B Mathematics

C Science

10. How much money her parents should pay if she attend to the school,

A nothing

B 150 pounds

C 250 pounds

例题 17

戏剧社

填空 3+ 搭配 4+ 单选 3

1-3 填空

1. Membership limitation: no children

2. Next membership start: October

3. Location: in the college

4-7 搭配

activity in following Months

4. June — E (art trip)

5. July — *** (Drama workshop training)

6. August — *** (Outdoor party)

7. September — *** (Planning meeting)

8-10 单选

8. “Now and then” is a

A Comedy

B Detective (干扰 in the past)

C Science fiction

9. "Now and then" is originally written for

A film (干扰)

B drama (干扰 not written for drama originally)

C radio

10. Now and then is good for people

A in their 20s

B love music

C remember late 60s

例题 18	图书馆	填空 3+ 搭配 4+ 单选 3
-------	-----	------------------

1. address: library in Skellran Street
2. located next to a park
3. Saturday Weekend: open at 9am till 4.30 p.m.
4. choose two activities: 4-13: drama club
5. singing for all ages every other Saturday
6. adult activities, she will meet local artists club
7. various magazines
8. can borrow film CDs
9. post cards, need to provide the card number
10. wide range has two souvenirs sales, *** and can also buy maps

例题 19	课程	单选 5+ 单选 5
-------	----	------------

1-4 单选

1. What is the course mainly about ?

A scenery

B object

C people

2. The class picture of farm: whom the class for improving

A children

B student

C children and adult

3. What is the destination of this field trip

A in France

B in Britain

C in Italy(Rome)

4. The man is going to make cards himself because the card is

A attractive

B personal

C expensive

5-10 填空

5. woman's name: Hardie

6. address: 40 Long Road

7. the course she took before : IT course

8. postcode:OX1 57Q

9. registration number: BL240879

10. painting course chosen and payment: cash

例题 20

健身俱乐部

填空 7+ 单选 3

1-7 填空

1. small gym is open exclusively to: women

2. new member can have a free health check

3. and (put a) program

4. for medical check, further meeting time with instructor every 6 weeks.

5. newly opened: yoga

6. additional facilities: a cafe

7. Beauty Salon offer service like: massage

8-10 单选

membership terms of the Gold, Silver and Off-peak Gold

8. A off-peak Gold membership cannot be applied in:

A in the evening of weekdays

B before 6:00 pm

9. Silver membership has to pay extra \$5

A every time using the club

B facilities

10. Gold membership: per month

- A \$250
- B \$57
- C \$50

例题 21	志愿者	填空 7+ 单选 3
-------	-----	------------

1. Number of hours: 5
2. Minimum working length: 5 weeks
3. most needed: during week
4. driving license
5. shopping
6. suit people who are friendly
7. window display
8. pick up rubbish
9. accommodation in a tent
10. reference

例题 22	社区课程	填空 10
-------	------	-------

CLASSES ORGANIZATION BY COMMUNITY CENTER

types of course	where	when	what to bring
photography class	in a library	Saturday 1. <u>morning</u>	2. <u>camera</u>
French cooking class	"Anita Kitchen"	3. <u>first</u> Tuesday in every month	apron 4. <u>money</u> to buy ingredients
beading class	5. <u>golf club</u>	Wednesday evening	beads
painting class	6. <u>high school</u>	Monday evening	own 7. <u>brushes</u> (optional)

Class Details

- the first class starts : 8. June 5
- cost of class : \$100
- the room is : 9. J52
- parking : next to a 10. station

例题 23

参加鸟类观察和保护活动

多选 3+ 填空 7

Birds Life

1. source for the money: donations
2. keep the record of the birds
3. the way of protection: keep watching nest
annual fee
children: £ 19
4. family membership fee: £ 54
5. there offers a guide to answer questions
6. family activity include: competition and outdoor games
special membership package
badge
7. children get poster and T-shirt (2 个空交替考)

How to join

8. pay by the post or by the phone
9. invitation should arrive in 25th August
10. Finally, they may be honored a gift of membership

例题 24

俱乐部

多选 3+ 填空 7

1-3 多选 (七选三)

Which THREE events happen every month ?

- A club discos
- B culture evenings
- C film nights
- D lectures
- E restaurant visits
- F Saturday excursion
- G theatre trips

4-10 填空

Club Facilities and Charges

activity	charge	additional information
become a member of the club	free	being registration from back to the 4. <u>club office</u>
use library	5. 15 deposit — payable when joining	open from 6. <u>11 a.m.</u> to 8 p.m.
trips	members pay for transport costs	usually to 7. <u>museum</u>
evening events	free entrance: \$2 payable for 8. <u>one more request</u>	***
discos	5 includes 9. <u>one free drink</u>	held at the 10. <u>Grand Hotel</u>

休闲娱乐

例题 1	小岛旅游	填空 10
------	------	-------

1-5 填空

1. Daytime Temperature : around 19 degrees
2. Normal Transfer time: 40 minutes
3. Every room has suite facilities and a balcony
4. Outdoor swimming pool to swim and play tennis
5. Every evening has someone play piano

6-10 表格填空

	Provides the Service	Transport	After Dinner
Tuesday	making the <u>6.fish</u> dishes	***	***
Wednesday	<u>7. helicopter</u> tour	by <u>8. cable car</u>	<u>9. tropical plants</u> garden
Thursday	***	***	watch a <u>10. firework</u> display

例题 2	预定迪拜旅游的航班	填空 10
------	-----------	-------

1. phone: 07958477222
2. the best time to call: Thursday morning
3. number of people: 7
4. return journey date: 22 November
5. purpose of this trip: wedding
6. special diet requirement: no cheese
7. last country visited: India
8. purpose of the most recent trip to foreign countries: business
9. customers' the comment on the website: too slow

10. email: carter.s@speedtech.com

例题 3	预定音乐会门票	填空 10
------	---------	-------

1. for: children
2. hope to have a piano performance
3. broadcast on a local radio station
4. evening concert
5. price: for student 4
6. lightening up by candles
7. Tuesday
8. charge by donation
9. no group discount
10. a special show of a famous singer

例题 4	罂粟花山旅游	填空 10
------	--------	-------

1-5 填空

1. the best time of watching is at the end of month
2. The Poppy Mountain is covered with color of orange
3. located at the East of the island
4. For security , people are recommended to wear trousers
5. This park is a state park (not a national one)

6-10 表格填空

Activity	Time	Duration	
6. general tour	***	1.5 hours	viewpoint of 7. <u>museum center</u>
***	***	8. <u>1 hour</u>	***
wildlife	9. <u>5.30</u> am to 1.00 pm	***	To bring the tripods and <u>zoom</u> lens of camera

例题 5	爵士派对	填空 10
------	------	-------

number: 80 people

time: Friday 26 September

room type: King

cake: lemon

congratulations

table

music: Jazz

master card digital number: 54412 00** 8877

name in card: middle name Sebastian

extra fee for service

例题 6	体育活动	填空 10
------	------	-------

1. painting
2. stadium
3. lake
4. track
5. speed
6. 9.15
7. hospital
8. party
9. May 30th
10. Germany

例题 7	旅游	填空 10
------	----	-------

1. www.greenride.com
2. a map
3. 5 hours (时长)
4. child seat
5. be a good place for bird watching
6. cost: guide
7. phone number: 026722
8. during: holiday
9. family
10. behind post office

例题 8	音乐节咨询	填空 10
------	-------	-------

1. June
2. 12
3. headache
4. tickets
5. Danlson
6. nurse
7. ***
8. sunscream
9. light
10. Thursday

例题 9	冬季音乐会	填空 10
------	-------	-------

1. 第一种音乐会需要 booking
2. 第一种音乐会传播方式 : radio
3. 第二种音乐会主题 : animals
4. 第二种音乐会孩子可以自己带自己的 instrument
5. 第二种音乐会门票免费但需要 : donation
6. 第三种音乐会上演时间 : Thursday
7. 第三种音乐会关于 : piano
8. 第三种音乐会费用 : £8.5
9. 第四种音乐会针对各种 ages
10. 第四种音乐会 experience

例题 10	小岛旅游	填空 10
-------	------	-------

1-7 表格填空

Location	Accommodation	Activities	Advice
***	live with his cousin	***	Bring more 1. <u>cash</u>
Town	***	new field	stay at least 2. <u>4 days</u>
***	3. <u>caravan</u> tour	Golden Beach activity 4. <u>sailing</u>	***

Location	Accommodation	Activities	Advice
6. <u>White Mountain</u>	***	7. <u>snow boarding</u>	***

8-10 句子填空

8. having cakes in the mountain cafe

9. you should hire a car

10. buy a map in advance

例题 11	表演安排	搭配 4+ 填空 6
-------	------	------------

1-4 搭配

A sold out

B no cheap tickets available

C dates changed

D new starting time

E cancel

F different performers

G for free

1. dance performance — D

2. jazz group — E

3. *** — G

4. *** — A

5-10 填空

5. address of performance: New Opera

6. ticket price £ 30

7. XXX(应该是一个什么表演, 问在哪里举行) Theater

8. Show(Millennium)- location: Library

9. Concert- location: Town Hall

10. Music- location Studio

例题 12	文体活动	填空 10
-------	------	-------

1. The ticket for the sport event: \$15

2. The music festival is in the park

3. contact number: 07144955321
4. The Saturday evening is music from the India
5. A market with people making and selling international food
6. The Sunday evening is for the local band about traditional songs
other events:
7. The exhibition is in the library
8. film festival
9. literature: Russian poetry
10. email: hengrave.internitonal@bureamond.com

例题 13

艺术节活动

填空 10

Art Fair

1. This started in: 1960s
2. Several workshops will be held
3. There are 325 local artists.
4. The most popular art fair: photography
5. University Art Fair
6. Audience are mainly international students
Children's activities
7. Kids can make models from clay
8. There are realist animals
9. Transport: A free purple double-deck
10. Leave the car next to entrance

例题 14

旅游

填空 10

1. price per night per person 8.37
2. minimum staying 2 nights
3. soap is not provided
4. the rooms are named after different types of music
5. one well equipped kitchen
6. 24 hours reception
7. valuable belongings into a safe
8. one day tour city

9. 2 days tour to see whales

10. helicopter tour is recommended

例题 15	预定旅行路线	填空 10
-------	--------	-------

1-5 填空

1. The cheapest price of a person: \$ 1100 (only this month)

2. Number of bike tours can choose from: 36

3. Most of the bike tours last for a week

4. Provide walking holidays as well as bicycling

5. Tour starts from Tuesday

6-10 表格填空

	Nights	Route	Attractions	Accommodation
South USA	6. <u>six</u>	Riverside roads and 7. <u>forest</u> trails	beautiful mountain	hotel
East USA and California	ten	8. <u>coastal</u> roads	9. <u>gardens</u>	a hotel and a 10. <u>farm</u>

例题 16	小岛旅游	填空 10
-------	------	-------

Holiday on Skippy Island

Stonebridge

Accommodation: in a guest house

Things to do: Shopping

Special food: local 1. cheese

Best place to eat in town center, by 2. market

Best night club is called 3. "Sugar"

Can go on a 4. helicopter ride to see the island

Camford

Accommodation: In a 5. hostel in the village

Things to do: Swim

Play 6. beach soccer

Theme Park with games and a 7. film about pirates for kids

Go 8. tree climbing

North of the Island

Mountain trail

Things to do: 5-day walk

lots of things for 9. fishing

don't forget to take a 10. towel

例题 17	展览	填空 10
-------	----	-------

1. Event date: 11th March
2. See and test products.
3. No cameras allowed in the museum.
4. If you do not pay in advance, \$165 is the price on that day.
5. Name of the road: Edgeworth
6. Address: Summer Street
7. Website: directions
8. Simplest way of booking: online
9. The best way people can go there: bus
10. An extra tour is included in the fees.

例题 18	活动安排	填空 5+ 搭配 5
-------	------	------------

1-3 填空

1. workshop

2. have a discussion

3. in a library

4-8 搭配

4. *** — F (short stories)

5. *** — A (biography)

6. *** — D (crime fiction)

7. *** — B (new novel)

8. *** — H (Written for children)

9-10 填空

9. booking / box office telephone No. 013667772

10. address: 24 River Lane

例题 19

新西兰旅游

填空 10

1. tour types: group trip
2. maximum days of stay: 13
3. month: November

Personal Information

4. Address: 4060, Liberty Road
5. tour agency: Adventure
6. 参与本次旅行 do not need: no visa required
7. choose journey for: view over mountain
8. tour sail they can see: dolphins and whales
9. offer free pick at the airport to hotel
10. extra travel please inform in : at the end of the holiday

例题 20

乘坐热气球

填空 10

1. the lowest price: £125 per person
2. Give a certificate to adult
3. on exact day you can only book: online
4. maximum height: 1800 meters
5. best time of the year is in autumn
6. there is no flight in night
7. the flight may be canceled due to the thunderstorm
8. take a jacket and a hat/helmet
9. there is no age restriction of adults
10. keep in and be able to stand position throughout flight

例题 21

订电影票

填空 10

1. Name: Bittens
2. group booking discount
3. Group ticket: adult 23
4. Children 12.5
5. Seat choice: the back row
6. A children needs a wheelchair

7. Better be close to lift
8. Ticket will collect from car park
9. They are vegetarians
10. Food: pizza

例题 22	Amazon 旅游	填空 10
-------	-----------	-------

1. bring a jacket
2. drive along Tucson along the desert trail
3. the possibility of playing the golf
4. specially recommended the Space Museum
5. parents' address: Fernleigh Drive
6. telephone number: 968322271
7. destroyed in (the fire happened) 1901
8. caused by firework
9. Grand Canyon: special tour by helicopter
10. wish go to the canoe, take sunscreen

工作

例题 1	求职	填空 10
------	----	-------

1. Name: Carilly
2. Transportation: ferry and airport
3. be familiar with children's family
4. parties
5. must be able to sing
6. experience is required.
7. training is provided
8. meals
9. starts on 13 July
10. on Wednesday

例题 2	应聘保姆	填空 10
------	------	-------

1. contact number: phone number: 0273891215
2. work time from 3.15 to 6.30
3. address: in the No. Park Road
4. have a certificate for .../ happy to have a student card
5. qualification of : skilled in swimming
6. interested in music and ***
7. job: washing and cleaning
8. by police
9. will attend a/an interview days before
10. working visa is not necessary(must have a passport)

例题 3	运输公司招聘	填空 10
------	--------	-------

1. Telephone number: 475888527
2. Company name: Vander

3. Transport: frozen food
4. Start from 28 August
5. Manager must have a degree
6. ***
7. Technician write a report
8. Truck driver — transport animals
9. Clean vehicles
10. Warehouse supervisor: a car

例题 4	航空公司招聘	填空 10
------	--------	-------

1. money
2. 168
3. math
4. language
5. illness
6. swim
7. cultures
8. Eurontas
9. team
10. uniform

例题 5	景区工作	填空 10
------	------	-------

Route	Difficulty	Distance	Attractions
Rainforest Long Walk	difficult	1. <u>12.5</u> km	Rock painting of 2. <u>fish</u> in the caves
Coastal Walk	difficult	***	· 3. <u>cafe</u> and <u>seafood</u> · a mountain of good view
The 4. <u>beach</u> / <u>Climbing</u>	intermediate 5. <u>moderate</u>	***	6. <u>pool</u> under <u>waterfall</u>

7. How to get the working place, You can take the No. 279 bus directly there.
8. Today is weekday so the last bus time is 5.30 p.m. on weekdays.
9. You will get off the bus at the Bridge stop.
10. If you pay the fee: You will get a map after buying the family ticket

例题 6

学生找工作

填空 10

1. Address: 7 Market Street
2. Area: South Park
3. telephone number: 07736545608
4. postcode: VIT613VL
5. current occupation: 2nd year university student (subject: drama)
6. preferred work: customer service (first choice)
cleaning (second choice)
7. level of spoken Spanish: fluent
8. specialty: drive car and minibus
9. time available: Wednesday to Sunday evening only
10. starting date: 27th August

例题 7

兼职工作

填空 10

Company Name	Duty	Reference Number	Contact Number
Power (manufacture company)	in a 1. <u>warehouse</u> section	***	Jane 2. <u>Hitch</u>
Cotton in 3. <u>supermarket</u> office	work in 4. <u>bakery</u>	5. <u>AEW204</u>	go to the office

Get information from:

6. ads
- buy a 7. paper
8. agency (女的说会考虑也找中介, 男的不建议她去)

Remember to bring:

- student card
can use a 9. tutor as a referee
还要填一个 10. feedback form

例题 8	兼职工作	填空 10
------	------	-------

1. Address: 8 HILL ROAD
2. Location: North Park
3. Postcode: CO2 9LU
4. Telephone number: 07743625
5. Preferred job: book keeping
6. Don't like: washing up
7. Major: politics
8. Spanish level: advanced
9. work time: Tuesday to Saturday
10. when to start: 25 September

例题 9	救生员工作	填空 10
------	-------	-------

- Name: xxx Smith
- Address: 130 South Main Road, Lake 1. Elsinour
- Contact number: 2. 077896245 cell phone
- Personal information: temporary job as a part-time 3. waiter
 is studying PE
 hope to be a high school 4. baseball coach
- Work experience: the 5. beach lifeguard
- Qualification: water safety
- Certificate expires to: 6. October (说 from November to October)
- Other relevant skill: 7. diving
- Other information: work on 8. Friday mornings
 start at 9. six o'clock
 get the in formation of the job: on the 10. radio (开车时听到的)

例题 10	求职	填空 10
-------	----	-------

1. location: Market/Station Road
 2. day: Sunday, working hours (all day days/hours 4)
- Job duties details
3. lifting heavy items

4. watering plants

Required skills

5. skills needed: math and

6. communication with customers

Interview information

7. interview time: 17.00/5 pm on Wednesday

8. name of the interviewer: Maria Rapana

9. contact number: 3438873

10. please bring passport to interview

龙腾教育微信号; LTJY28888

租 / 住

例题 1	租房子	填空 10
------	-----	-------

1. available date: 5th May
2. rent: £ 1700
3. 15 for a credit check

Amenities: 3 bedrooms and 2 bathrooms
 a remodeled 4. kitchen
 a 5. garage with work area
 no 6. dishwasher

Utilities:

the landlord will provide landscaping service, but the tenants must 7. water grass
 rent includes trashing and 8. recycling

the tenants should pay for electricity, water and gas bill

other: there is no central air conditioning but there is a 9. window conditioning unit
 name: Sam 10. Dressier

例题 2	租房	填空 10
------	----	-------

1. advantage: large garage
2. disadvantage: too much traffic
3. advantage: view of river/street
4. disadvantage: noise of train
5. name: Ferriz
6. advantage: garden
7. disadvantage: pet
8. advantage: popular park
9. length: 6 months
10. telephone no. 0419826854

例题 3

选房

填空 10

Features

1. a studio apartment
2. a shared laundry
3. the view of harbor
4. outside: a balcony

Facilities

5. a gym
6. 2 cinemas
an indoor pool
7. underground parking

Rent

8. 580 per month
9. electricity included
10. available from 13 August

例题 4

租房

填空 10

House Detail

- a small 1. swimming pool
 2. dining room
 a short drive away from 3. supermarket
 near a 4. park
 an excellent 5. primary school
 a 6. garage
 rent: 980 per month
 includes the maintenance of the 7. garden
 date: available after 8. 23 April
 viewing appointment time: Wednesday 9. 10.15
 address: 10. 127 Spring Street

例题 5

短期出租

填空 10

1. empty for: 2 weeks

- 2. rent: \$400 per month
- 3. apartment number: 17A
- 4. telephone number: 889740
switch on
- 5. water heater
- 6. fridge
- 7. price of cleaning \$25 for whole session
rules
- 8. must lock all windows before go out
- 9. must not play music after midnight
contact electrician and technician
- 10. for more serious problems, call the landlady

例题 6	学生找房子	填空 10
------	-------	-------

Student Accommodation		
Type	Cost	Contract
Example: single room	<ul style="list-style-type: none"> · Standard: £ 3276 per year · En-suite: 1. £ <u>3834</u> per year (meals are not included) 	36 weeks (rooms are not available during the 2. <u>holidays</u>)
3. <u>home welcome</u> room with a family	<ul style="list-style-type: none"> · £ 150 per week - all inclusive 	arrangements are 4. <u>flexible</u>
Private renting: room in a share house or a 5. <u>studio</u>	<ul style="list-style-type: none"> · From £ 275 to £ 490 per month additional cost (for this year) · Gas and electricity 6. £ <u>48</u> per month · water: 7. £ <u>9</u> · 8. <u>transportation</u> 	<ul style="list-style-type: none"> · 6 months need 9. <u>deposit</u> · two 10. <u>references</u>

例题 7	房屋出租	填空 10
------	------	-------

1-2 单选

- 1. What is preferred location
A near station

B near leisure center

C near park

2. The accepted rent range is

A under 450

B 450-600

C above 600

3-5 填空

3. name: Jacobs

4. occupation: Engineer

5. date of Move in: 1st August

6-10 分类

What's the woman's attitudes towards the following house choice ?

A very interested

B not sure

C not interested

6. Rouge House — B

7. Winter House — A

8. Hamilton House — C

9. Milton House — C

10. Sugar House — A

例题 8	租房咨询	填空 10
------	------	-------

1. water gas meter

2. turn off clockwise

3. key kept in bookshelf

4. every 3 months

5. noticed: 4 weeks

6. furniture and decoration

7. garden extra parking

8. plants removed

9. tenants not allowed pets

10. internet

例题 9	预定酒店	搭配 6+ 填空 4
------	------	------------

1-6 搭配题

- A. Royal Hotel
 B. Star Hotel
 C. Winchester Hotel
 D. all of three
1. sea view — B
 2. disable access — D
 3. 孩子们玩的地方 — C
 4. choice of food — A
 5. private dining room — A
 6. group discount — C

7-10 填空题

7. send deposit to the
 hotel
 8. need help with transport
 9. do not send presents
 10. make invitations

例题 10	欧洲旅行住宿	填空 10
-------	--------	-------

1. 到达日期 : 15
 2. 第一周住的地方 : hotel
 3. October
 4. 项目 : sailing
 5. golf
 6. massage
 7. fishing
 8. caravan
 9. menu
 10. 175

例题 11	酒店预订	填空 10	
Name	Facilities	Location	Price
***	***	***	***
***	***	1. <u>supermarket</u> nearby	***
2. studio room for 6 people	beautiful 3. <u>furniture</u>	close to a 4. <u>sport center</u>	***
for 4 people	large table and 6. <u>terrace</u>	***	5. \$ <u>219</u>

Thursday

7. menu : salad with fruit

Friday

8. barbecue for family in picnic area and

9. day is on Saturday

10. also guests can dance with a band

例题 12	酒店预订	填空 10
-------	------	-------

BMD Hotel

1. morning activities: running tour

Price includes free breakfast

2. Afternoon: sailing

3. Room with a little balcony

4. fish market have a pottery factory nearby

the 2nd hotel

5. Location close to a beach

6. Activities: shopping mall nearby

7. Afternoon Activities: go to see local birds

The 3rd hotel

8. price includes free internet/television

9. there is gym nearby

10. Afternoon Activities: cycling

例题 13	婚礼场地	填空 2+ 分类 5+ 填空 3
-------	------	------------------

1-2 填空

- Gate Hotel is located in Bridge Street
- Shalford Hotel is a popular conference centre

3-7 分类

- Gate Hotel
 - Prince Hotel
 - Shalford Hotel
- old fashioned intel — C
 - large garden — B
 - inconvenient location — B
 - a good choice of menu — A
 - limited parking — A

8-10 填空

- basic package: £ 4800
- £ 17.95 for each person, 3-meal including coffee
- name: Mrs Cornell

例题 14	活动场地	单选 8+ 填空 2
-------	------	------------

1-8 单选

每次团体旅游能容纳几个人

- 15
 - 20
 - 38
- how is the meeting room now
A meeting room unavailable
B flooded
C ***
 - 什么情况用餐要预定?
A ***
B the farmer cooks for them
C ***

4. 去农场可以干什么？

A hear information about organic farming

B ***

C ***

6. 去最近的地方怎么去？

A ***

B ***

C cycling route

7. 如果下雨的话，可以去哪里？

A ***

B ***

C museum

8. 预定付多少钱

A 提前支付全部

B part of the money

C on arrival

9-10 填空

9. address: Cotehele

10. postcode: SH121LQ

龙腾教育微信号; LTJY28888

日常生活

例题 1	儿童玩具	填空 10
------	------	-------

1. a set of gardening equipment
2. include: a pair of children's gloves
3. include: seeds of various of kinds
4. children playing with water or sand
5. a pump
6. building blocks
7. made of plastic
8. a puzzle
9. chain
10. beach

例题 2	户外活动产品	填空 10
------	--------	-------

order reference: 1. 5174XCM

Items to be booked

- a family sized tent with door at the front and back
- sleeping bags with the design for 2. summer
- air mattress (need a 3. pump to below it up)
- a gas stove

need a big 4. bottle to put water in

should bring cooking 5. plates

the handle of the torch is made of 6. rubber

bring a 7. baseball suited for children

need a recent 8. map

address: 56 9. Taupo Street

delivery price: 10. \$25.50

3. woman concern how to pay on the Internet
4. they made an appointment on Saturday to teach the woman how to do the on shopping
5. woman can help man to do with the letter on job application

6-10 单选

6. The reasons of online shopping for the man and the woman

A cost less (the woman thinks so)

B save time

C a lot of choices

(男人说网购不见得会花费少,且等一些时间才会收到)

7. The risk of shopping online is

A poor quality

B instructions are confusing

C the payment system is unsafe

8. The benefits of online shopping

B (CDs) from other counties are available

9. What else is needed for online shopping?

A email

B telephone number

C a help line

10. The man said we should pay attention when buy

B fresh products (like food)

date: available after 8. 23 April

viewing appointment time: Wednesday 9. 10.15

address: 10. 127 Spring Street

例题 6

儿童礼物

填空 10

1. the boy's gift: wooden truck(model)
2. the gift can improve children's awareness of technology
3. another gift bird feeder
4. price £ 8.99
5. chocolate packed with boxes
6. pay attention to temperature
7. website www.rimona.com

- 8. when shop online, you need to click gift to pay your issues
- 9. free postage
- 10. with free message too

例题 7	电话公司套餐	填空 2+ 多选 3+ 填空 5
------	--------	------------------

1-2 填空

- 1. Monthly paid 14 pounds
- 2. The charge is 0.8 pence/minute, if it exceed 70 minutes.

3-5 多选 (7 选 3)

- THREE services provided no extra fee?
- reminder of the last 5 calls
- call diversion/renew password

6-10 填空

- 6. access to internet
- 7. bills need to be paid every 3 months
- 8. contract can be ended at any time
- 9. sending email need to rent a line
- 10. customer need a password

例题 8	城市建设满意度	填空 10
------	---------	-------

address: Fowler Road

postcode: RO6 2LR

man's occupation: waiter

ation of the city

streets

tion health services is poor

police is good

es from: there are many parks available for him to walk with his wife

ient and of high quality

ask the local people

nd to be improved, others are fine.

例题 9

游客采访

填空 10

Surveys on Visitors of Green Bay Resort

1. original reason: a conference
2. present reason: a wedding
3. arrive at: by coach
4. type of accommodation: small camp
5. not enough meat
6. easy to walk: no insects
7. restaurant rather noisy
8. nice to have a cinema
9. occupation: cook
10. dream destination: India

例题 10

街头采访

填空 10

1. current occupation: salesman
2. how long live here: 9 years
3. area: living in spring park
4. accommodation: a shared apartment with 2 friends
5. private transports on foot and by bicycle
public transport: trains and taxis
6. diet: frequency of eating out: once a month, not just every week.
7. entertainment: the places people usually go
activities: goes swimming and clubs
8. cinema
9. exercise: always goes to gyms
activity: go sailing
10. part-time course: Japanese for large classes

例题 11

汽车维修

填空 10

1. name: Wollowey
2. address: Flat 6
3. the number of car: RH139YS

4. NX55JGY
5. the type and the color of the car: metallic grey
6. cannot walk very well
7. present location in a petrol station
8. cross a bridge over a river
9. transfer to a hotel
10. lunch of time to get help: within 30 minutes

例题 12	垃圾回收	填空 10
-------	------	-------

1. garbage collection on Tuesday
2. take the garbage out at 8:15pm
3. bags can be bought in any grocery stores
4. company does not collect any TV
5. a map on the Internet is available
6. garbage is divided into categories
7. egg cartons
8. clean, empty water and juice bottles
9. remove the labels
10. empty pizza box

例题 13	照片刊登	填空 10
-------	------	-------

1. Newspaper page: front page
2. newspaper story: Parkhurst
3. photo subject: athlete of the week
4. photo use: personal aim
5. Image type: color photo
6. Price: \$80
7. Process method: normal
8. payment type: cheque
9. delivered method: by mail
10. reading frequency: every day

例题 14	投诉	填空 10
-------	----	-------

1. name: Quigley
2. She wants to buy 4 tickets: return tickets
3. leaving / departure at 11:45 am
4. the words on the website page: error message
5. can only take 2 kids/children (但她有3个孩子分别是11岁,8岁,5岁)
6. free tickets for kids under 12 years old
7. she thinks it is unfair for large families and school group
8. children need less food
9. letter to go to the manager
10. reference No.GBK8422(回忆暂不确定,因为考生们的回忆中G,J各占一队,好悲伤)

例题 15	病人背痛	填空 10
-------	------	-------

1. full name: surname Riryard
2. address: 27 station Road, Marton
3. the position of the pain: used to injured his elbow, now he has pain in his lower back
4. get hurt: lifting up a box
5. the doctor's first suggestion: treatment with painkiller
6. the second suggestion: treatment with aspirin an ice pack
7. date of birth: 25 February, 1975
- history: when does the pain start to hurt
8. since 3 days ago +
9. when it gets worse most recently: today's afternoon
10. please ask information about 24 hours in advance

保险

例题 1	保险理赔	填空 10
------	------	-------

1. reference number: CWX576884
2. last claimed time: 9 months ago
3. postcode: GO9 4KE
4. address: 120 Middle Street, Oxford
5. the floor which is made of wood was wet
6. because of leaking water
7. it was out of control and she switched off immediately
8. contact the client engineer to come and check the problem
9. the client inspector could come on Tuesday next week
10. the repair company is opposite to/facing the post office

例题 2	保险理赔	填空 10
------	------	-------

1. Policy reference number: JXY456773
2. Name: Troudford
3. Address: 98 Crown Road
4. Postcode: PG32BK
5. Previous claim: bicycle
6. Time: 10 months ago
- Damage:
7. Floor in the bathroom
8. Wall in the bedroom
- Pipe in the bathroom
- supermarket

例题 3	保险理赔	填空 10
------	------	-------

Insurance Claim

Name: Peter Brown

1. Policy Number: TWS701942
2. Address: Yerongpilly
3. Reason of claim: storm
4. Date of incident: August 16
5. Previous claim: bicycle was stolen

Details

Building: 6. pool

7. Some bricks were cracked; Location; near the 8. garage

9. a window in a bedroom was broken

Content

10. a computer was damaged

例题 4	保险理赔	填空 10
------	------	-------

Quotation for Insurance

1. Address: 19 Hallway, Deighton
2. Daytime phone number: 04295 477039
3. House layout: with three bedrooms
4. Age of the house: 40 years
5. House material: made of stone
6. Additional property: a garage
7. Security feature: no alarm
8. Equipment insurance: office equipment (\$1000)
9. Equipment insurance: freezer (\$500)
10. Start date: 1st April

例题 5	保险理赔	填空 10
------	------	-------

1. telephone number: 1**77***
2. address: Arkansas
3. date of shipping arrival: 27 February

other items:

4. lost 10 paintings
5. mirror in a golden frame
6. whole box of books
7. an old tube/desk which was made of wood
8. a Chinese gift of a plate
9. desk and chairs: the leg is broken
10. total value to be claimed is \$3450

龙腾教育微信号; LTJY28888

搬运 / 邮寄

例题 1	个人物品搬运	填空 10
------	--------	-------

1. items can be moved: bicycles
2. items cannot be moved: weigh more than 40 kg
3. for safety reasons, liquid and food are banned
4. containers made of plastic
special service
5. delivery on Saturdays
6. organization of storage

Examples of past delivery:

7. transport a 15kg goods and a violin from UK to Sweden
8. cost \$ 575

Payment

9. debit or credit card over the phone or cash to the driver

Document needed

10. photocopy of the passport

例题 2	搬家公司	填空 10
------	------	-------

1. customer reference number: 55678 19230
2. moving date 21(st) August
3. needs to be moved to new address: electricity
4. protection policy for a cooker
5. home movers company arranges a credit card
6. approximately 3 days prior to moving
7. central heating services for £ 85
8. phone the customer and then email you
9. free booklet provided on new appliance
10. information about energy saving from website

例题 3	邮寄包裹去美国	填空 10
------	---------	-------

1. address: 59 Franklyn Avenue
2. postcode: TH1 70S
3. telephone number: 01658867 (8:00-4.00)
4. 喜欢什么类型的房子 traditional style (前面说 modern 的不喜欢 location: near the Park Square)
5. inside: central heating (因为如果没有这个, 居所内的费用会很高)
6. outside: garage (garden 不是必须的, 但是车库必须有)
7. 地点: village (虽然在 center 工作, 但是喜欢居住在乡村)
8. 价格: £ 102 per month
9. branch: Park Square (这个是 branch bank 的 title)
10. collect

例题 4	邮寄服务	填空 10
------	------	-------

1. the lady starting a job in Australia
2. a short period of time
3. the lady used an address of her friend at first
4. it is free for initial 2 months
5. name: Jennifer Simmons
6. address: 16 Ocean Drive
7. postcode: 176832**
8. date: 22nd September
- 9-10 多选

What does the woman send?

- A files
- B medicine
- C ** instrument
- D diving equipment
- E books

龙腾教育微信号; LTJY28888

Section

2

LTJY28888

龙腾教育微信

龙腾教育微信号; LTJY28888

生活资讯

例题 1

英国驾照以及交通

单选 5+ 搭配 4

11-15 单选

11. What do you need to exchange driving in UK?

A media report

B current non- UK license

C current residents in UK

12. What does speaker say about transaction (witness interpretation)?

A need to got to a official agency

B not always necessary

C company service included

13. Why the photos rejected?

A wearing glasses

B Cream background instead of monogrey

C in poor condition

14. How does speaker think about the check service?

A speed up the process

B the information of forms is confused

C ***

15. Suggest for quick application:

A look for personal recommendation

B compare for low prices

C filed via the internet

16-20 搭配

16. London — A (clear sign)

17. Edinburgh — G (good traffic light)

18. Cardiff — B (multiple lanes)19. Manchester — E (ring roads around the city)

20. Oxford — F (many roads into the city center)

例题 2	钓鱼执照	搭配 10
------	------	-------

11-14 搭配题

11. If you want to fish there you need to tell them — F (your passport number)
12. If you don't have one, you need — D (proof of passing a fishing exam)
13. You can go to the local bank for the fishing costs, regulations and ask for — B (details of how long one can stay for the holiday)
14. Then you will find — C (details of accommodations one takes on the island)

15-20 搭配题

15. pine tree beach — G
16. Oyster Ocean — H
17. Riper Bella — B
18. Marton Reservoir — C
19. Southern coast — F
20. Reservoir — E

例题 3	汽车交易	单选 5+ 地图 5
------	------	------------

11. C the number of people each week
12. A differences of entry fee
13. B document of car
14. B sign of car
15. C advice for car owners
16. Cars under 5000 pounds — D
17. Cars between 5000 to 10000 pounds — F
18. Cars above 10000 pounds — H
19. Caravans — A
20. Motorbikes — E

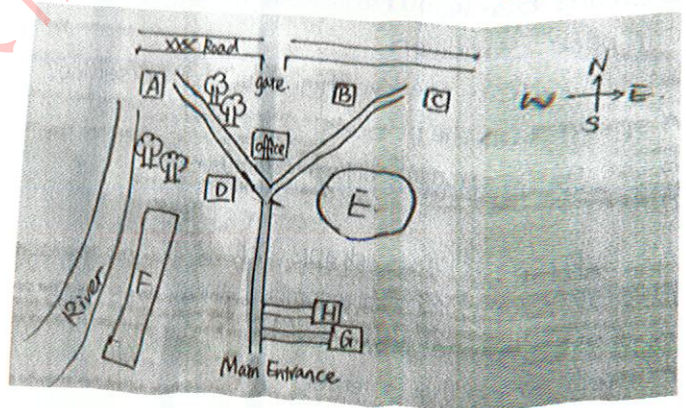

例题 4	种菜的方法	单选 5+ 搭配 5
------	-------	------------

11-15 单选

11. A (选择经常吃的蔬菜种)
 12. B (不要种植太多)
 13. A (选择适合植物的种植场所, 不一定需要光照或大量的水)
 14. B (选择 seeds 种植, 因为可以分季节, 分不同的 stages 去种植不同的种类)
 15. C (剩余的蔬菜不要丢掉, 可以和别人交换)

16-20 搭配

16. C (planting— 需要 used containers)
 17. A (feeding— 用 waste food 施肥)
 18. B (protection— 用家里的 old furniture)
 19. E (weeding— 下雨后, wet condition)
 20. F (temperature— 温度太低要保护)

例题 5	健康食品	单选 6+ 多选 4
------	------	------------

11-16 单选

11. A (不选 organic food 原因 too expensive)
 12. A (惊讶于过分包装, 比如 orange)
 13. C (家庭环保, 本地都用 insulation)
 14. A
 15. C (环保活动的意义, 培养环保意识)
 16. B (机构如何促进人们使用自行车, 提供 discounted helmet)

17-20 多选

- 17-18
 B rechargeable
 E re-frozen regularly
 19-20
 B meeting people
 D improve 社区环境

例题 6	垃圾回收	单选 6+ 多选 4
------	------	------------

Green Bin

- Advantage: 11. waterproof
- Remember:
 - do not put in 12. building waste (e.g. wood)
 - do not 13. overflow the bin
 - green bin don't accept 14. heavy items

Blue Bin

- do not put items in a 15. plastic bag
- extra material can be put in 16. open containers

Night Collection

- due to 17. traffic problems
- in 18. business districts

Gardens

- garbage collected every 19. 4 weeks
- do not recycle dirt or 20. stones

例题 7	买房子	单选 6+ 多选 4
------	-----	------------

11-16 单选

11. What kind of "Closing Cost" is involved when buying a house

A inspection fee

B survey fee

C title fee

12. What has to be bought each month? (这道题不确定问题是什么了)

B insurance cost

13. Which group of people would buy the house in Bella Street?

A A larger budget

B a small budget

C no budget

14. Which is Archadelle Street suitable for?

A families

B children

C walking

15. Chardeville Street has characteristics of

A many walking parks

B many supermarkets

C very clean

16. The characteristics of Block 3(记不太清楚什么路了)is

A older place

B new place

C place with good views

17-20 多选

17-18. What are the TWO disadvantages of the apartment?

A too noisy

B too far

C too small

D too crowded

E too XXX

19-20. What are the TWO advantages of Condo?

A most affordable

B cost less

C no property tax

D no bank charge

E most desirable

例题 8

节约能源

单选 6+ 多选 4

11-16 单选

11. What was Jill surprised about?

A the work on the house will start soon

B the house was poorly insulated

C she could get financial help

12. What does Jill say every family can do straight away?

energy-saving bulbs

turn the thermostat

replace appliances completely

13. What is Jill pleased about the energy provider?
A reduce the price with prompt payment
B allow online payment by customers
C have a reduction of price of the energy-saving sources
14. What difficulty does Jill have with the energy meter?
A they are difficult to access
B The figures are hard to be read accurately
C she can't tell whether it's for electricity or for gas
15. What energy-saving method does Jill going to take next?

A Install double-glazed window

B use energy-saving boiler

C have the walls checked with insulation level

16. Why is Jill doubtful about the renewable energy

A she thinks it's unsuitable for her house

B she don't understand the technical details

C she believes it's too expensive

17-20 多选 (五选二)

17-18. Which TWO water-saving tips does Jill recommend?

A use more showers than baths

B keep the washing machine full before using it

C boil as much water as you need

D turn off the taps while you are brushing your teeth

E repair leaking tap

19-20. What TWO topics do people most frequently ask?

A the ideal temperature of the thermostat

B whether to leave the light on or not

C use more computer than laptop to watch movies

D how to work out the running cost of the appliances

E if the sun panels only work on sunny days

例题 9

植树节

填空 7+ 多选 3

11-17 填空

11. More than 20 million trees are planted since the first festival

Benefits

- 12. provide people and animals shade in hot weather
- 13. reduce traffic noise
- 14. lower peopled stress levels
- 15. reduce the risk of flooding

Threats

- 16. not convenient because of new housing constructed in rural area
- 17. insects bring more diseases as a result of changes in climate

18-20 多选 (五选三)

A art exhibition painting

B make art from wood create things (sculpture) from wood

C ***

D ***

E new publication

例题 10	租房	分类 4+ 地图 6
-------	----	------------

11-14 分类

A. flat B. house C. Hostel

- 11. garden — A house private garden size
- 12. garage — A house need extra pay
- 13. security...alarming system— B
- 14. new furniture — B

15-20 地图 (配对)

- 15. Bank — E
- 16. House in front of the pool — B
- 17. Hostel — D
- 18. flat — A
- 19. postoffice — C
- 20. bus stop agent — G

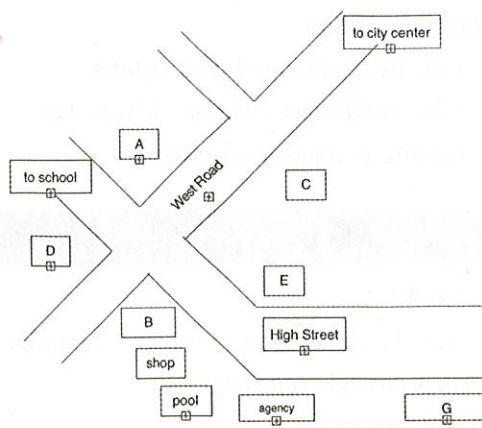

例题 11	防火知识	填空 10
-------	------	-------

Protecting Your Property From Brushfire

· plants

- choose plants with 11. soft leaves
- trees
- Do not plant trees too 12. close
- No branches hangover the house
- firebreak
- allow it between 13. 10-15 meters
- roof
- secure the roof with
- no 14. gaps in the roof
- remove/clean the 15. rubbish from roof
- other
- move 16. gas tanks away from the yard
- notice
- make sure all the 17. family is aware of bushfire
- put emergency number near the phone
- store documents in bushfire container
- get a radio and extra 18. batteries
- other information
- bush fire usually occurred in 19. October
- bushfire service office number: 1300 654 443
- 20. training for volunteer in 4 weeks

例题 12

机场交通

单选 4+ 地图 6

11-14 单选

11. Why did T say not to take the Super Shuttle bus?

A it only accesses to certain hotels

B it takes longer time

C it does not have regular depart time

12. What does T say about the *** Shuttle bus ?

A it is not convenient to get to the station

B it does not in service during the night

C no suitable busy stop

13. *** bus: about the airport station Momorius

A sign in the stop

B get off at the third stop

14. What did T tell Jane about the ***'s ticket ?

A she needs to buy 2 tickets

B check the ticket during the journey

C she can use the ticket for both leave and return

15-20 地图 (搭配)

15. Lincoln Avenue — B (beside the river)

16. *** Hall — C

17. Taxi Rank(pick up point) — E (not the station; opposite the main entrance)

18. Bus Stop — I (on the Chopter Avenue,turn left)

19. Cafe — D (side entrance of the A** Hotel)

20. Restaurant — G (across the street from the hotel)

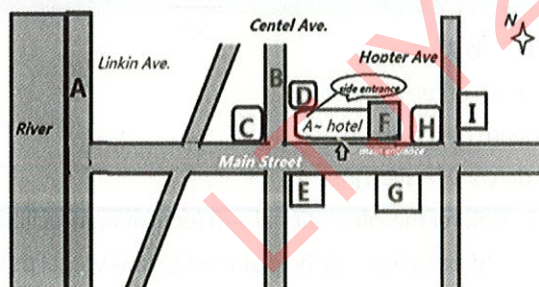

龙腾教育微信亭;

工作信息

例题 1	去斯里兰卡做志愿者的工作经历	分类 5+ 单选 5
------	----------------	------------

11-15 分类

A teach other something

B learn new skills

C do conversation jobs

11. explorer the international — B (educational facilities in small villages in Ghana)

12. wild exchange — A (help and get to know local people...farm...South America)

13. track abroad — C (community center for example, mathematics or...evenings in Himalayas)

14. go adventure — C (two months in Tanzania, endangered species...teach in the farm...caring for animals)

15. need qualification — A (forest and lakes, sharing, woodcraft, patient; to be patient with kids)

16-20 单选

16. What kind of job in the zoo

A repair carpet

B washing and caring elephant

C riding elephant

17. What problem when she first arrived there

A feel homesick

B boring

C being ill

18. Activities with friends on weekend

A serve a travel guide to adjust swimming

B coach tour to coast area in someday

C go to ***

19. Volunteers divided into groups based on

A the same interest

B the same age

- C the same background
- 20. The result of being the volunteer
- A ***
- B being proud of achievement
- C confident after coming back

例题 2	给新员工介绍公司规章制度	单选 5+ 地图 5
------	--------------	------------

11-15 单选

- 11. Where should employers be when it's time to work in busy or mild season ?
- two different finishing time
- 12. annual holiday leave rule you have to leave at some fixed time
- 13. When water the building
- you sit in your place for work
- 14. ***
- 15. ***

16-20 地图 (选择)

- 14. bathroom — I
- 15. locker room — J
- 16. load dock — G
- 17. *** — B
- 18. medical room — E/D
- 19. production manager's office — C
- 20. cafeteria — H

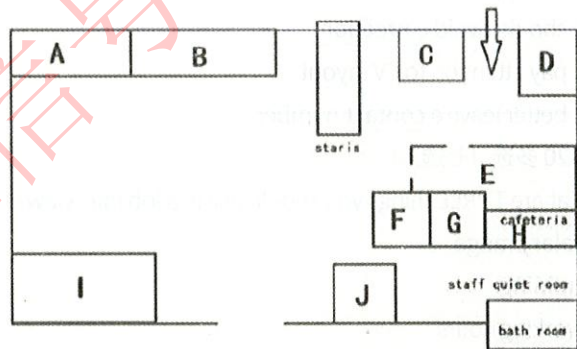

例题 3	邮局工作	单选 3+ 多选 3+ 填空 4
------	------	------------------

11-14 分类

- A do it today
- B next few days
- C not his responsibility
- 11. collecting incoming post — A
- 12. answering customers on the phone — C
- 13. reading customer emails — B
- 14. updating client database — A

- 15. B authorization
- 16. H purchase number
- 17. C approved supplier list
- 18. G filling order form
- 19. A contact
- 20. E delivery note

例题 4	求职简历以及面试	填空 7+ 多选 3
------	----------	------------

11-17 填空

- 11. recommend to use the internet to find a job
(The teacher recommended lots of other choices to look for a job, Such as agency newspaper. But the priority is internet.)
- 12. resume cannot be too long
- 13. all documents should be: typed
- 14. the application should include a list of your experiences and lists of qualifications
- 15. should avoid correction
- 16. pay attention to CV layout
- 17. better leave a contact number

18-20 多选 (七选三)

What are THREE things you should ask in a job interview?

A salary range

B training

C working hours

D allowance for holidays

E promotion prospect

F pension allowance

例题 5	雷诺电器公司	填空 10
------	--------	-------

- 11. The first product made by Reno technical is cars. (原文 manufacture cars)
- 12. Tony technical was first built in 1928. (原文说了四个数字, 1907, 1908, 1928, 1958)
- 13. There was a cinema where the company was based.
- 14. The quality of the product is an important factor for the company.
- 15. The company is building a new factory recently. (原文说的是 another)

16. The company won an award for reducing waste. (原文说的是原句)

Monday	17. <u>website</u> development
Tuesday	change to the 18. <u>safety</u> arrangement
Wednesday	communication with 19. <u>customers</u>
Thursday	visit the market
Friday	there is enough 20. money

例题 6	求职培训课程	填空 10
------	--------	-------

Aim of this course:

- 11. gives information to seek opportunities
- 12. to increase applicant's confidence and experiences
- 13. to give contacts names and phone calls

Course	Object	Time	Things to Bring
***	14. <u>young employees</u>	1 hour	nothing
15. <u>written documents</u>	everyone	2 hours	CV
further education	interested in 16. <u>promotion</u>	17. <u>45 minutes</u>	nothing
18. <u>networking</u>	everyone	1 hour or more	19. <u>application form</u>
20. <u>self-employment</u>	experienced employees	2 hours	nothing

例题 7	求职	填空 6+ 单选 4
------	----	------------

job	advantage	disadvantage	advice
stocktaking	11. <u>travelling</u>	tiring	12. <u>good shoes</u>
office staff	air conditioning	13. <u>formal clothing</u>	choose a 14. <u>large office</u>
theme park attendant	15. <u>good pay</u>		16. <u>live nearby</u>

17. Where did Peter find the job? B internet

18. Why did Peter choose this job ? A easy B challenging C unusual
 19. Which does Peter like of this job ? B work with children
 20. What will Peter do during his vacation? A he wants to find a job

例题 8	服装公司招聘	单选 1+ 填空 9
------	--------	------------

11. 单选

11. In order to succeed, clothing firms should?

A competitive price

B introduce new product

C good publicity

12-20 填空

three types of professions the firm is looking for

12. scientists

13. accountants

14. engineers

personality demanded

15. to be collaborative

16. to be loyal

17. to be hard-working

company' s welfare provided

18. company will offer free transportation

19. The firm provides a fitness center for employees and their family

20. the company organised a seminar about the latest development in fashion in workplace

例题 9	夜晚上班	单选 4+ 填空 6
------	------	------------

11-14 单选

11. The night shift maintaining department staff will get pay of

A extra high salary

B can handle the emergency

C the same to normal shift

12. work in the office

flexible working hours

13. when staffs arriving offices, they should

A register in a book

B ***

C input number in a machine

14. Female staff in sales department may the collar can wear T-shirt, jacket with:

A pattern skirt

B a sweater

C dark trousers

(you can wear skirt or trousers, but pattern is not allowed. she preferred sports wear rather than a sweater)

15-20 填空

15. shoes must be flat

16. keep password secret

17. employees in IT department take files home

18. Don't wandering around without ID

19. *** department can take photographs/photos inside the building

20. For some problems can contact manager or personnel officer (两个空交替考)

课程信息

例题 1	烹饪学校的课程和布局	搭配 6+ 地图 4
------	------------	------------

11-16 搭配题

Special Features

- A with one particular ingredient
- B learn about food history
- C have individual cooking lessons
- D make meals for college students
- E prepare healthy meals
- F go on a guided walking tour
- G make time-saving meals
- H go on an afternoon tour

- 11. Northern California — C
- 12. Italy — H
- 13. New Orleans — B
- 14. Budget Feasts — F
- 15. Cooking for Two — E
- 16. Variations in Theme — A

17-20 地图题

- 17. Oven — C (in the hallway, you can see a big table, pass it you will see it on the left)
- 18. Refrigerator — F (next to the storage)
- 19. Demonstration Kitchen — D (pass the hallway, kitchen is the largest)
- 20. Utensil Cabinet — B (on the right of exit)

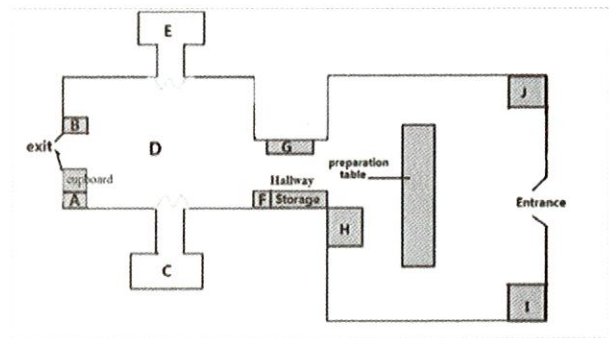

例题 2	夜校课程	多选 4+ 搭配 6
------	------	------------

11-12 多选 (5 选 2)

Choose TWO art courses which students need to bring their own materials

A cards making

B watercolor painting

C calligraphy

D to make mosaics

E interior design introduction

13-14 多选 (5 选 2)

Which TWO courses need more than one term to finish ?

A solve problems in internet design

B cooking and practical garden design

15-20 搭配

several courses about fitness and their suitable people

15. Yoga — *** adults and children (the whole family)

16. Lacrosse — *** specially priced (expensive instructors are from overseas)

17. music dance — *** changes to a new place (larger space)

18. tennis — *** famous sports players (a well-known celebrity)

19. Golf — *** holds regional competition (have their own team and have some local awards)

20. Taiji — *** minimal age required (above 60 years old)

例题 3	课程	单选 4+ 地图 6
------	----	------------

11-14 单选

11. the most popular course this year is

A news reading

B music class

C foreign language class

12. which part is the most difficult one

A organization skill

B technical skills

C teamwork skills

13. the purpose of this Town center Radio station

A involve local community issue

B entertainment

C family events and solve social problems

14. the community was firstly for

A caravan

B kitchen

C shopping center

15-20 地图 (选择)

15. cafeteria — C

16. storeroom — B

17. practice studio — G

18. cup cleaning — D

19. waiting room — F

20. control room — E

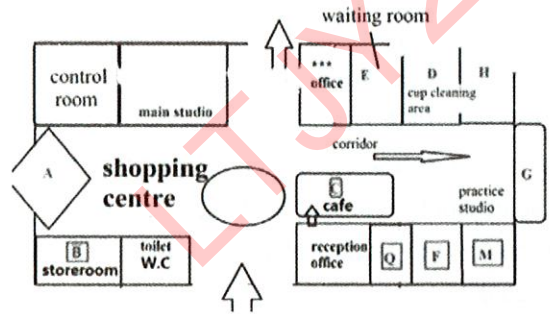

例题 4

学校介绍

单选 6+ 搭配 4

11-16 单选

11. Which course was the most popular last year?

B photograph

12. What Latin course was not going to open this year?

C teacher broke her leg

13. What does the tutor recommend to do tonight?

B communication with teachers

14. Timetable changed because

A Term is short

15. Who will take charge of the class

C Full-time teacher

16. Who will get a discount?

A newly enroll students

17-20 搭配

A new to the university

B appeared in a magazine

C appeared in a TV program

- D contribute to a charity
- E Has worked for 25 years
- F *****
- G Published a well-known book

- 17. C (channel five)
- 18. G (write a novel)
- 19. E (quarter of a century)
- 20. D (donate to charity)

例题 5	学校介绍	地图 6+ 填空 4
------	------	------------

11-16 地图 (搭配)

- 11. enquiry desk — A
- 12. dining room — G/H
- 13. science building
- 14. bike-parking
- 15. ***
- 16. ***

11-16) Map (Matching)

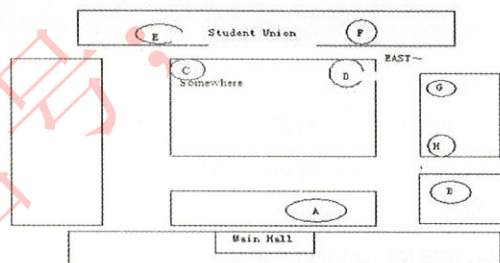

17-20 填空

- 17. weekend at library: 9.30-6.30pm
- 18. have question with assignment should look for a general tutor
- 19. You should take student card to register in campus clinic
- 20. emergency telephone number: 455455

例题 6	驾校课程	多选 4+ 地图 6
------	------	------------

11-14 多选

- 11-12. Basic course
- A English proficiency
- B It takes several days to finish
- C completed in one session
- D conducted on road
- E for person who has a driving license
- 13-14. Safe driver course

- A involved traffic violation
- B theoretical and practical elements
- C receive tuition fees
- D compulsory course
- E use new equipment

15-20 地图 (搭配)

- 15. shopping mall: B
- 16. police station: A
- 17. ***
- 18. ***
- 19. hospital: D
- 20. post office: E

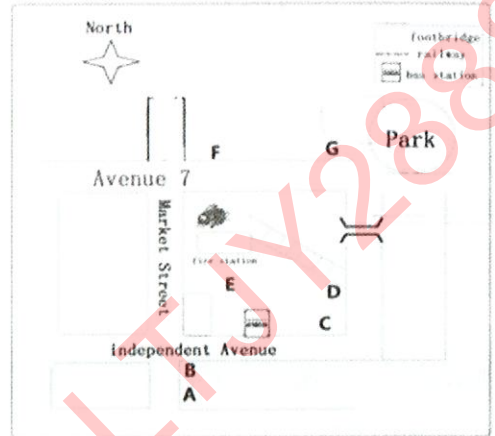

例题 7	驾校课程	多选 4+ 地图 6
------	------	------------

11-14 多选 (五选二)

11-12. What are the **TWO** things mentioned by the speaker about XXX Orchestra?

- A most players are experienced
 - B lose members recently
 - C looking for younger players
 - D rehearsal twice a week
 - E looking for flute players
- 13-14. What are the two things about a new program?
- A a guest performer
 - B play a new performance
 - C one performance will be recorded for TV
 - D perform on a tour around local area
 - E a piece of music specially written for the Orchestra

15-20 搭配

- A new performers
- B new performance
- C program aimed to children aged over 10
- D hired a new director
- E backstage helper

- F perform outside
G free performance
H two tickets for price of one
15. sky theater — B
16. orange theater — F
17. coco
theater — D
18. city player — A
19. xxx theater — G
20. green art theater — E

例题 8

音乐学校

填空 10

11. The location of the new campus: opposite the library.
12. There are 14 classrooms.
13. A car park is near the swimming pool.
14. The available website: www.playwell.com
15. They teach all level of violins. (for those lower than level 3)
16. drum (above level 5)
17. piano (for level 3)
18. There is a concert being held in June and December.
19. CDs will be given as awards.
20. The performance will be given in a concert.

运动信息

例题 1	健身中心儿童托管训练	多选 4+ 搭配 6
------	------------	------------

11-12 多选 (5 选 2)

What did the woman say about children?

A more space for children to play

(原文: about children we now have two new 场所之类的 for children)

B special class for children

C children for all the days

D children care are free

E meal are provided

13-14 多选 (5 选 2)

About fitness class?

A weighting training

B dance class

C dancing class for teenagers

D for new staff(原文:一开始会有)

E more day time more evening class

(原文:新阶段不会再有)

15-20 配对

A won more than one award in his city

B disabled after injury

C retired from tennis

E married with famous people

F donate winnings to kids(help young children)

G favoured by fans

H from Australia

I titled in French

15. kimberly - C (retired)

16. Martin – B (get injured during match)
 17. Robert – A (won more than one-award in his city)
 18. Edward – E (married with famous actor)
 19. Andrew – G (favored by fans)
 20. Tommy – F (help young children)

例题 2	健身房	单选 6+ 多选 4
------	-----	------------

11-16 单选

11. What to do before joining the gym ?

- A know how to use every equipment
 B get a form from medical check with a doctor
 C make individual health plan with the help of instructor

12. Which type of dance is offering currently?

- A Latin
 B modern
 C hiphop

13. What is the feature of the hot shot program tennis course?

- A special equipment for adult beginners
 B special equipment for young teenagers
 C special equipment for kids

14. What benefit can children have when exercising with parents ?

- A lose weight
 B build up confidence
 C avoid injury

15. What benefit can children have from exercising?

- A become healthy when getting older
 B perform better in competitive sports
 C have better social relationship

16. What benefit can members have?

- A ***
 B ***

C members have cheaper price

17-20 多选

17-18 What TWO facilities can people use in the gym at the moment ?

- A small shop
- B hair dresser
- C spa center
- D conference room
- E cafe

19-20 What TWO things are provided free this months?

- A healthy consultation
- B parents
- C entry to the gym
- D swimming pool
- E family package

例题 3	运动中心	地图 5+ 搭配 6
------	------	------------

11-15 地图 (地图暂无回忆)

- 11. locker room — G
- 12. women's fitting room — J
- 13. gym room — H
- 14. man's fitting room — F
- 15. squash court — F

16-20 搭配

- 16. fitness machines — *** (build up overall strength)
- 17. mats exercise — *** (help body flexibility)
- 18. cycling class — *** (good for lower limbs)
- 19. aerobic class — *** (increase heart health beat)
- 20. weight training — *** (keep concentration)

例题 4	运动中心开业	单选 6+ 搭配 4
------	--------	------------

11-16 单选

- 11. The purpose for this activity new course:
celebrate the opening of dance studio
- 12. The most popular day for this centre
A weekends

B weekday evenings

C Monday to Friday

13. How can guest get a discount

A book in advance

14. what is the special offer

A free training hour with a coach

B free cup tickets

C free membership to 20 people

15. why did they win an award

A trainer provide high quality in practice

B website centre a lots information

C offering professional advisers

16. why did some guests finally quit

Busy with study or work

17-20 搭配

A release stress

B the leg strength

C recreation

D better concentration

E quick react/short react time

17. general training — B

18. weight training — D

19. aerobics training — A

20. squash — E

例题 5

健身俱乐部咨询

分类 5+ 单选 5

11-16 选择

11. equipment update

12. 有一个 course, 受欢迎, 以后会更好 B will be successful

13. 周末开放情况: 半天 half a day

14. Membership card: A monthly B costly C annually

15. 这个 club 之前做什么的? (答案暂无回忆)

16. 怎么进去? write name

17-20 地图

- 17. badminton court
- 18. café
- 19. bathroom
- 20. swimming pool

Questions 17-20 Mapping

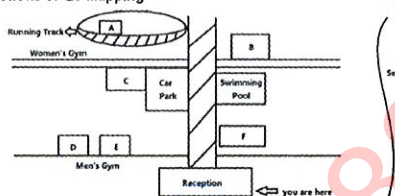

例题 6	体育馆庆典活动	单选 6+ 搭配 4
------	---------	------------

11-16 单选

11. What's the main purpose of this promotional campaign?

for anniversary

12. who are invited?

journalists

13. What is the specialty to be proud of for the skate rink?

A two champions have been trained here

B is one of the biggest rink in the country

C it encourages children to participate in sports

14. What is the next plan for this complex

A for expansion for more space

B extension for longer opening hours

C adding business of selling equipments

15. What to do if you want to offer a helping hand?

A join the committee

16. What people are specifically employed as part time

employed mother with children

17-20 搭配

A has one on one coach

B features on TV drama

C beneficial for young people

D restriction as just open for women

E the bigger of country

F rent for a part

17. Swimming pool — C (beneficial for young people)

18. gym — A (one-on-one coach)

19. skating rink — E (the biggest of the country)

20. climbing walls — B (features on TV drama)

(选项顺序不确定)

例题 7

冰壶运动

填空 6+ 单选 4

11-16 填空

The Game of Curling

the four player on the team are called the 11. Lead, the First, the Second and the Skip;

the length of ice on which the game is played is called the 12. Sheet

the target area is called the 13. House

the main pieces of equipment used are made from stones and brushes:

the Scottish brushes are made of 14. horse hair

a shoe needs a sole made of of the 15. rubber

the captain of the team often carries a 16. stop watch

17-20 单选

17. Montreal curling club is famous as

A the champion club in the League

B the oldest club in the region

C the most influential club in winter sports

18. Caledonian curling club is formed in order to

A attract interests in sports

B train young players

C fix regulations for the game

19. in the 16th century, curling avoided being banned because

A it was already so popular

B it was good training for battle

C it was only played by children

20. The early curling club in Canada used implements of?

A local material

B imported stone

C cast iron

综合信息

例题 1	项目介绍	填空 10
------	------	-------

11. What is called in international program: open gallery
12. What is the theme of this new competition: 'On the Street'
13. in the theater foyer

Name	Nationality	Present Job	Interesting Thing
Annie	14. <u>Australia</u>	workshop	collecting old 15. <u>maps</u>
16. Kesteven	British	running a 17. <u>picture library</u>	18. <u>wildlife</u> photograph
***	Mexican	lecturer from college of 19. <u>design</u>	20. <u>sports</u> photograph

例题 2	图书馆	填空 10
------	-----	-------

11. 134 titles in UK and America
12. company annual report
13. borrow: company trade journals and profiles
14. bookshop at the fifth floor
15. price for borrowing DVD films: £1.95
16. standard return period for books: 4 weeks (renew: 8 weeks)
17. how many books can rent maximum: 12 books
18. 24 computers in the library, among them 6 for teenagers
19. borrow book need PIN and electric card (use computer need PIN number)
20. open late on Thursday & Friday

例题 3

铁器时代

单选 5+ 搭配 5

11-15 单选

11. The man in the Iron Age village

A felt cold

B get up early

C ***

12. What about the food there?

A. take a long time to prepare

B contain some fruit such as berries

C eat quickly

13. The most important work for blacksmiths was

A amend the broken tools

B ***

C maintain the good source of heat

14. What did they like to do after dinner around the fire?

A They are too tired to eat

B Most food are berries

C They talk about what they have done

15. What the man like most?

A varied work

B share knowledge with others

C do much exercise

16-20 搭配 (选词填空)

16. Wooden peg into the ground (G)17. Tools are made from animal bone (A)18 Use roof scaffold (I)19. Wood of hazel (E)20. Distance between each peg should equal length(C)

例题 4

船的历史

单选 5+ 搭配 5

11-15 单选

11. Change of Lutta in 1901

B added sail

12. Eventual sailing plan

B around the world global)

13. problem during the trip

A loss of instrument (compass)

14. Sailing to M. with the purpose of

B let it seen by more people

15. Destination of the boat

C Victoria

16-20 搭配

A help steer the boat

B dock at fisherman Wharf

C observe marine animals

D observe bird life

E cooked fishes

F take vehicles with them

G maritime history

16. Tiny Tug — A

17. Ocean Magic — C

18. Sea rider — F

19. Starship — E

20. Porter — G

例题 5

国际周

单选 5+ 搭配 5

11-20 单选

11. The businessmen in the town decided to hold the international week in

A February

B August

C September

12. Why did they change from one day to a whole week

A local newspaper suggest change

B the organisers want raise additional money

C more people want to show their countries

13. If it is bad weather, where should they move to

A School gym

B radio station

C town hall

14. How the oversea team attend the performance

A submit a good proposal

B obtain membership of an organisation

C pay a small application fee

15. Out door activities will be held

A in college ground

B in the local stadium

C in the community centre' s parking lot

16. How does the businessman support this fair

A help with the cost of administrations

B offer furniture equipment

C donate books about the countries

17-20 搭配

A Music

B Dance

C Costumes

D Cookery

E Wood carving

F Sports

17. Mexico — B

18. South Africa — C

19. Indonesia — D

20. Canada — E

例题 6

红松鼠的照片

单选 5+ 填空 5

11-15 单选

11. How does Darren think squirrel's Latin name?

A suitable for this species

B meaningless

C an interesting description

12. Why squirrel's number reduced?

A an invasion of Exotic species

B Disease brought by Exotic (干扰 the number has already declined before the disease squirrel here)

C **Decrease of food nuts** (exotic species snatched food of squirrel)

13. The boy knows that red squirrel is different from rats, because

A different food category

B how the food was eaten (mouse eat a hole on the nut, but red squirrel open the shell by two parts, and get the nut out of the shell)

C the way they restore food

14. What is restriction when Harem was photographing?

A only one animal allowed at a time

B only use one camera

C **it only allows taking photograph in a certain location**(the photographer said that at the beginning there's one place for shooting which is at his garden)

15. Why Dian thinks that he can shoot better photos?

A lot of practice

B **got valuable help from tutor**

C equipment: camera is better

16-20 填空

16. The photos will exhibit in local museum

17. They will send the photos in competition of national newspaper

18. The second one: take advantage of 'light', Harem thinks the best light is in late afternoon

19. The third one: he thinks a good photo should contain all the record of detail notes in order to be improved in the future, so it is called 'secondary object'

20. Darrel's picture was once rewarded on a newspaper for the third prize

Section

3

LTJY28888

龙腾教育微信

龙腾教育微信号; LTJY28888

课程选择

例题 1	17 世纪音乐课程介绍以及评价	单选 6+ 搭配 4
------	-----------------	------------

21-26 单选

21. What does the girl most like about the music performance ?

A structure

B rhythm

C melody

22. Students opinion about the professor

A care students

B focus on his subject

C only concern personal achievement

23. Why didn't the lecture mention the content of 'leak out'?

A he thinks those are not important

B focus more on subjects / too much included in one topic

C teacher has a bad memory

24. Why did the boy choose to learn the music in 17th century?

A he uses the knowledge already learned / feel confident with

B discuss interest things with others

C useful to future career

25. What's the girl's opinions about the facilities?

A impressive / satisfied

B disappointed

C unacceptable

26. Why does the content of music in seventeenth century like this?

A past staff's interest

B demand by present students

C influenced by a previous staff's research

27-30 搭配

List of qualifications

A help to be a musician

B self-assessment

C individual ability

D historical reason

E help to be a leader

F improve relationship

G shared interpretation

27. materials used — C (looking for materials for themselves)

28. concert group — G (do research together)

29. reviewing system — A

30. understanding directions — D (sixteenth century music scores)

例题 2	外语学习以及选课	单选 4+ 搭配 6
------	----------	------------

21-24 单选

21. Why does the man want to change the course?

A go abroad and find work from other country

22. What does the man think about the course economics?

B uninterested, boring and dull

23. The woman's opinion about choosing the course

C optional

24. Why does the woman Anna want to have the Foreign Course?

C It is useful for business and commerce

25-26 多选 (五选二)

What do they think about the lecture?

A encourage student to have free thought

B the professor is enthusiastic about the lecture

27-30 搭配

27. Communication 1 — *** (speak in public)

28. Psychology — *** (team work in large group)

29. Interpretation — *** (cooperation)

30. Communication 3 — *** (reduce quarrel caused by the culture difference)

例题 3

选专业

单选 5+ 搭配 5

21-25 单选

21. Why does the student want to study Tourism?

A good future

B good pay

C parents' will

22. What kind of skill will the student gain in the course?

A time-management

B financial planning

C note-taking

23. The student has the ability of

A independence

B communication

C coping well with statistics

24. The teacher believes that the industry of tourism is

A shrinking

B seeing a bright future

C growing popular.

25. How does the student compare the university course with polytechnics?

A There are summer schools

B The course is structured in modules

C The price is reasonable.

26-30 搭配

26. travel and business/ tourist and economy — D intense classes and should finish in a short period, 8 months

27. Culture — G (leadership)

28. Japanese and Mandarin — A (language skills)

29. mechanical operations — B (medicine skills (often meet outside accidents))

30. computing of tourism — E (customer relationship)

例题 4	选课程	单选 6+ 搭配 4
------	-----	------------

21-26 单选

21. What did we never want discuss this selective course immediately ?

A It's the final day

B The selective course will be full very soon booked up

C they don't have time later on, deadline is in 3 weeks

22. What is the compulsory course for all students

A the language course

B business study

C the mathematics

23. How to find the information of statistics

A useful

B inconvenient

C involves a lot of work

24. What will they do before choosing the selective schools

A to consult the students about teaching quality

C whether there is exam or not

25. How did they feel about the art design class

A surprising

B confusing

C valuable

26. What a week and Nina are sure about the selective schools?

A how they have to register the course

B when the course will take place

C amount of work will be done on line

27-30 搭配

A the course's been improved gradually

B professor's note is detailed

C involved lot of practical work

D professor explanation is clear

E useful material online

F harder than expected

27. Metallurgy — E

28. Fluid Mechanics — D
 29. Computing — A
 30. Energy economy — C

例题 5

足球裁判课程

填空 10

21-23 单选

21. What does Jenny do recently?

A watch football match

B playing football

C football training

22. What did Steve do last week?

A supervising the team

B referring a football match

C doing medical examination

23. What is required to be a referee

A need a lot of experience

B do not need certificate

C have to be 18-50 years old

24-25 完成句子

24. His class will start at 8 a.m. on Saturday and finish at 6 p.m. on Sunday.

25. The total number of referees: 60

24-25 单选

26. Why does the man take incentive class ?

A find a place in university

B finish the course shortly

C making money

27. What does the disadvantage of this place?

A lack of practical course

B the course is beyond them

C too many textbooks

28. What is the hardest part of the exam?

A difficulty in exam

B the length of oral exam

C writing

29. does the man think of unfairness that those female football players receiving?

A regrettable

B puzzling

C exaggerating

30. Why doesn't the man want to be a referee?

A not enough respect

B limitations in a career perspective

C work too much / low pay

例题 6	换课程	填空 10
------	-----	-------

Original course: Politics

He wants to change to

1st choice: 21. Journalism

2nd choice: 22. business studies

problems	tried strategies	tutor's advise
course difficult	23. <u>recording</u>	24. <u>review</u>
***	more careful 25. <u>preparation</u>	attend 25. <u>support unit</u>
poor assignment	27. <u>reading</u>	28. <u>outline</u>

29. next appointment time: February 17

30. contact with senior advisor

例题 7	选择 field trip	单选 5+ 填空 5
------	---------------	------------

21-25 单选

21. In order to go to the trip, student must

A inform their tutor

B register the admission

C fill in the application form

22. How much of the cost should university pay ?

A 450

B 1000

C 2000

23. A biology's definition of a desert is

A water evaporates faster than it falls

B less than 4 cm of rain

C rare rain

24. The destination of the trip is

A desert grassland

B marine desert

C desert scrub

25. The field trip has been chosen because of

A its animals

B its plants

C its birds

26-30 填空

26. the trip is only designed for undergraduate student

27. students will be on a ship as the base of the trip

28. students will have to write a journal every day

29. the oldest plant in the area is 12000 years old

30. the tour guide recommended a reference book called baked earth

例题 8

学生咨询老师选课内容

多选 4+ 搭配 5+ 填空 1

21. The course is available for

C part-time and in work

22. part-time job is only offered to

A work at home

B ***

C students at working (most of...students from out the city or of farmlands)

23. microbiology science available for

A full-time and flexible study time

24. Who are interested in Microbiology courses?

A people out of campus

B people who work for industry

C people who need work experience

25. Why medicine science not open till next year?

A lab facilities are not available (没有实验设备)

B sufficient support from local hospital

C the lab equipment is too expensive

26. What subject is increasing the quickest?

C. environment science (microbiology)

27-29 搭配

(从表格的大约八门课中选出三个专业相同的必修课)

A. medical science

B. computing

C. mathematics

D. statistics

E. biology

F. medicine laboratory technology

G. medicine introduction

There compulsory courses:

27. 三年都要学 - C

28. 第二年都要学 - E

29. 所有学生都要学 - F

30 填空

三个关于全额 scholarship 的 benefits:

30. tuition offered every year

grant of 1500 cash

book allowance

例题 9

换专业

单选 5+ 流程 (搭配) 4

21-25 单选

21. Why Katie is continually is attending the lecture?

A gain credit

B get good reference

C to see if she changes her mind

22. Why Katie want to tell her family?

A good advice

B disapprove of her decision

C funding

23. What does S talk about Sport Education course?

A good reputation

B easy to get job

C Katie will enjoy it

24. What factor does k agree with

A extra pay

B make up missed course

C ***

25. Katie thinks the degree

A is helpful only you enjoy it

B route to job

C ****

26-30 流程 (搭配)

Ask 26. tutor for requirement

Give 27. finance office date

Email to 28. welfare director

Ask 29. library / administration office to change data

Notify the 30. hall of residence

例题 10

护理课程

填空 4+ 单选 6

21-24 填空

21. They did not choose clinic nursing, because diploma course is too difficult

22. Choosing operation need to learn biology first

23. If they choose Health course, they will work with young people

24. One course later on work specialist in disability

25-30 单选

25. What Mr Fraser suppose them to do

A two subjects

B focus on one subject

C choose another subject

26. Millie think the professor of course

A work for government

B worldwide reputation

C granted for research

27. The textbook of the course

A written by this school staff

B written by a professor

C easy to understand

28. The university has recently spent money on

A upgrading the buildings for medical school

B lecture theatre

29. The most important thing is to

A whether there is tutor for each one

B is there any personal tutor system

C ask by yourself and know about tutors

30. What they choose in the end

A choose the same course

B want another talk to their teacher

C remain uncertain

例题 11

课程评价以及反馈

搭配 7+ 单选 3

21-27 搭配

A catering to different levels

B resources in adequate

C created disagreement

D plenty of choices

E omitted some information

F not necessary

G entirely positive experience

H not convenient for every one

21. pre-course information — E

22. lecture timetabling — H

23. library resources — D

24. tutorial system — G

25. teaching — A

26. IT support — F

27. discussion grouping — C

28-30 单选

28. What subject does Diana want to specialize in?

A marketing

B accounting

C product managing

29. What does the tutor want Diana to do after she handed in the proposal?

A a break

B go to enrol on a new course

C get work experience

30. What help can the tutor offer to Diana?

A write a reference letter

B introduce some companies

C some contact names

例题 12

选课

搭配 7+ 单选 3

21-26 分类

A Henry

B Jane

C Both

21. first time of the kind — C

22. energy institute — C

23. vocational elements — A

24. key companies — B

25. well-equipped lab — A

26. good teachers — B

27-30 单选

27. In the first year, Henry is looking forward to learn

B survey

28. Aim of BSC module is

B management skills

29. Energy institute is famous for

A wave energy

30. What did Jane want to find out?

A registration arrangement

例题 13

考古课程介绍

填空 10

Archeology Course

The course can have all courses except 21. classical history

The course is the 22. compulsory courses

Course 1:

Title: 23. Object Matter

Lecturer: Dr. Williams

Method: Recording

24. Classification

Interpretation

Display

Assessment: 25. course work

Course 2:

Title: 26. Towns and Cities

Lecturer: Dr. Elliot

Content: The 27. origins and development of the built world

Assessment: 28. Oral examination

Course 3:

Title: Method and Science

All basic field study methods

Assessment: 50% course; 50% 29. seminars

Site survey at the end of the course (the 30. location will be announced later)

例题 14

选课

填空 2+ 单选 4+ 搭配 4

21-22 填空

21. feedback on photocopy of the outline

22. The lecturers will give the audience a handout.

23-25 单选

23. What does the woman think is important?

A The topic relevant part (the most important thing is to read those paragraphs chosen)

B ***

C ***

24. What does the woman think is the hardest?

A ***

B Understanding theory

C ***

25. Why does the lecturer think making notes is important when reading a passage?

A ***

B ***

C Go back for reference

26-30 搭配

26. Statistics of social science — *** (be helpful for mathematics)

27. Quantities Method — *** (practical examples)

28. Mathematics — *** (take less time than other courses)

29. Basic of Economics — *** (for the last year students)

30. dissertation planning — *** (good tutor)

例题 15

选学校

分类 4+ 填空 6

21-24 分类

A Hasn University

B Con University

C Both A and B

21. 哪个大学要 4 年 — C

22. 哪个大学的野外调查是必修课 — B

23. 哪个大学同时有 seminar 和 lecture — A

24. 哪个大学需要完成课程作业 — A

25-30 填空

25. 关于 Portugal 的调查是有关 ecosystem

26. 可以借到任何的 equipment

27. 学生需要带上 map

28. 学校费用不包括生活开支 living expenses

29. 有人出版了一本书书名是 Survey Methods

30. 博物馆有一个关于 insect 的展览

例题 16

护理专业学生的课程反馈

单选 5+ 配对 5

21-25 单选

21. Students think the age for students studying in nursing course?

A almost all teens

B around twenties (干扰)

C has a wide range of age groups

22. Professor ask the opinion on group study?

A make friends with different sorts of people

C supportive studying environment/cooperative

23. What the advantageous feature for the study ?

B problem-solving

C create cooperative learning environment

24. What surprised them in the study ?

A the number of essays

B the deadline

C study stress (干扰: knew the course could be hard, 早知很难, 不惊讶)

25. What do you think about the legal aspect to freshmen ?

A it is an essential part

B too theoretical

C take too much time

26-30 搭配

A get feedback from teacher frequently

B do background reading

C support particular help from nursing staff

D support from university

E be well prepared

F should review notes regularly

G preview the background

H set realistic target

I time management

26. library research — C (become friends with librarians)
 27. Online forum — D (get help from university)
 28. Lectures — F (should review notes regularly)
 29. write assignment — I (time management)
 30. placement test — H (well-prepared, should write study diary; also should be achievable)

例题 17	向新生介绍 pre-sessional course	填空 10
-------	----------------------------	-------

21. register with medical center
 22. must join in student union
 23. take part in activities at organization, it offers two or three clubs
 2-5 Days
 24. use the self-access lab
 25. library resources can be searched via electronic directory
 6-7 Days
 26. please show the ID of terms of course codes of subject
 27. test structure
 28. provides guideline reference(s)
 29. tutors will give you the feedback and teach you how to write essay online
 30. assignment will be form of the PowerPoint/PPT in OHP(over-head projector)

例题 18	课程学习中心	填空 10
-------	--------	-------

21-24 单选

21. This centre is open for
C all students in the university
 22. Membership charge \$20 valid for
B all the services whole year
 23. Computer room should be reserved in advance because:

A seating capacity is limited

24. Job responsibility
B weekly emails update

25-30 填空

25. academic writing
 26. required to make presentations

27. we should learn study skills
 28. discuss in small group
 29. go to ask information from reception staff
 30. part-time in summer school

例题 19	学生对学校课程的评价反馈	分类 6+ 多选 2+ 填空 2
-------	--------------	------------------

21-26 分类

A Both agree

B Neither agree with nor disagree

C Disagree

21. need advertise services more and academic support — B
 22. course outlines are good — B
 23. the other materials the course need to read — C
 24. Feedback for assignments — A
 25. The library's resource and not enough rooms in the library's problem — A
 26. There are not enough materials to use due to the large number of students— B

27-28 多选

27. Which TWO parts of college should be improved:

A accommodation facilities

B catering facilities

C healthcare service

D rental facilities

E sports center

29-30 填空

29. need to advertise service more widely
 30. job shop: if you want part-time work throughout the academic life

例题 20	课程介绍	填空 10
-------	------	-------

Course outline

21. total numbers of hours
 22. range of English level know the present volunteers proficiency
 23. college resources available on the campus

Details of course

24. names of the teachers
25. objectives of Summary essays
26. unusual methods
- Course components
27. textbook lessons
28. skills focus
29. cultural media studies
- Social problems and transport
30. research subjects: skills example: business visits and activities

例题 21

选课

填空 10

21-26 单选

21. Why does Penny recommend a three-year placement?
- A Students can focus on research
- B Most students choose it
- C Students can choose where to do the placement
22. What made Penny apply for one particular university?
- A the attractiveness of the course
- B the prospect of graduate employment
- C the reputation of the university
23. What did Cosmo worry about?
- A Whether he had enough working experience
- B Whether he could get a higher score
- C Whether he studied in the wrong subject
24. What is Cosmo's purpose of studying abroad?
- A to meet different people
- B to be more independent
- C to widen academic experience
25. What was Penny's aim in her dissertation?
- A explored both views from the debate
- B better understood the subject
- C knew about the fact
26. Why does Penny recommend postponing the dissertation?

- A ask other students' opinion
- B think about the course
- C do some exploratory research first

27-30 搭配

- A assessed by the dissertation
- B is mainly online
- C deliver two terms
- D the most popular of the optional module
- E hard to sign up
- F share with students from other courses
- G assessed by laboratory report

27. Green Technology — F

28. Enterprise — B

29. Bio course — D

30. Separation course — G

作业讨论

例题 1	关于小组完成作业的讨论	单选 4 + 搭配 6
------	-------------	-------------

21-23 单选

21. Why did they choose this topic ?

A many respondents available

B many students interested in this topic

C relevant to the discipline

22. What is the problem of the original design of questionnaire

A too many separate parts

B questions are with open-answers

C the wording of questions is quite hard

23. What is the percentage of people support the group work discussion?

A 60%-20%-20%

24-30 填空

Advantages:24. more opportunities to experiment25. good for developing social interactions26. decrease the reliance on the teacher

Disadvantages:

27. problem of unexpected noise28. unbalanced skills improvements29. a large group is difficult to monitor control30. in a gradual way

例题 2	老师辅导学生作业 (澳大利亚 3 人)	单选 6 + 搭配 4
------	-----------------------	-------------

21-26 单选

21. What is th

eir research method

A interview

B observation

C questionnaire

22. What is the background of this topic based on?

A an Australian study

B similar study someone has done before

C something completely new

23. How do the professor think of to divide the groups?

A reduce the number of the groups

B reduce the number of children in each group

C build more groups

24. How does the professor suggest the survey should be done?

A various people or sectors

B don't be too ambitious

C practicing using the data table

25. practicing using the data table?

A replace it

B simplify it

C try to practice it

26. The professor asks them do they have read enough reference books?

A enough

B they don't have enough time

C have to spend one more week

27-30 搭配

A Jane will do

B Douglas will do

C They will do together

27. Final report — C

28. Sheet preparation — B

29. Transcription — C

30. The letter — A

例题 3

老师辅导女学生提高成绩

单选 4 + 流程图 (填空) 6

21-24 单选

21. Sara's grade is bad because

A the passage is too long

B expressed a different opinion from her professor

C didn't support the essay with enough evidence

22. problems with examples (not effective)

A ***

B some of them are not appropriate relevant

C need more important examples

23. Jen find it extremely difficult to

A write informative introduction

B topic decided

C decide how much detail to include

24. Professor's suggestion

A try to prepare the view for targeted readers

B try to read in other's standpoint

C read more of other's writing ahead of her

25-30 流程图 (填空)

25. decide the purpose of the essay

26. find out what the reader knows and expects

27. collect only relevant material

28. write one sentence to summarize the whole academic report

29. write an outline note

30. write first full draft

例题 4

老师辅导两个学生写论文 (3人)

单选 5 + 填空 5

21-25 单选

21. KATE thinks that the essay is inappropriate if

A discuss both sides

B express too much own views

C refer to a range of views

22. Asked the books (bibliography)

A there is a standard format (论文传统形式)

C the title of the article should be underlined

23. How did John think of the article

A incorrect idea

B more data analysis

C the writer should do thorough research for his essay

24. The conclusion that the professor recommended is:

B refer to title they (who wrote the book) should go back the basic parts

25. the tutor said that they could use the viewpoint in the article

A to quote heavily in order to get a high score of this article (it would not be good if you do not understand and just quotes other's view point)

B it is helpful for definition of difficult task

C there are less quotes in students articles

26-30 句子填空

26. Kathy thinks it is a good essay to separate several sub-topics

27. The man says these articles look like reports rather than essays.

28. The man thinks it is good to use as many examples as possible.

29. and use connectives to link his ideas

30. the Professor recommends a (wide) reading

例题 5

学生讨论如何完成作业

填空 10

subtitles: summary report

SECTION 1

21. mention the number of students

22. report findings

SECTION 2

23. focus on the area of improvements

24. the nature of research

SECTION 3

25. title: action points / plan

26. size of sample

27. 研究方法 methods: interviews and questionnaires

SECTION 4

28. title: project background
29. case studies
30. if you are going to miss the assignment / contact your personal tutor

例题 6

儿童健康饮品调查报告

填空 10

21. 要调查的产品是 aim to children
22. 要做 data research
23. 男生要负责收集数据 trade figures
24. Check performance of similar products
25. 在本周完成 first section
26. 开始准备产品描述 detailed product description
27. 男生可以借女生相关资料是一个 booklet
28. 里面有一个 useful checklist
29. shop manager
30. 女生要准备 media plan

例题 7

学生请教老师关于论文事项

填空 7+ 单选 3

21-27 填空

Focus on reasons for choosing:

21. sample
22. software used for research

Different instruments for different kinds of people:

23. observations for managers
24. surveys for employees

General advice:

- refer to add particular 25. reference when making points
- supply additional 26. statistics to make recommendation
- explain in details 27. application of the research findings

28-30 单选

28. How does Dr advise the student to respond to criticism?

A accept comments without argument

B give solution for specific problems raised

C be assertive for his own idea

29. How to take note?

A take brief points through out

B take key points at the end

C take notes completely

30. What immediate future plan for the student?

A publish short article soon

B write a whole book based on his thesis

C gain more experience before publishing anything

例题 8

老师辅导学生写 proposal (3 人)

单选 3+ 填空 7

21-23 单选

21. The tutor explains that the project proposal

A will be checked by two examiners

B will be awarded to final grade

C will be returned with feedback

22. The proposal focus on

A the topic

B the method

C the result

23. The tutor explains the length of the proposal

A limit should be strictly observed

B the word of the proposal should be at least 6,000

C no restriction

24-30 填空

Proposal Requirement

Content

Special interest of topic. e.g. Language development

State issue of reliability, e.g. 24. interview and observe many people

Presentation

Should use correct 25. font

Use student number on every page

Give in 26. two copies(deadline: 27. 11 May)

Permitted to 28. change the project if necessary(send a 29. note or call the tutor)

Structure of the proposal

Hypothesis

Description of the 30. procedure

例题 9	老师辅导一名学生如何做 presentation	填空 10
------	--------------------------	-------

21-24 单选

21. The tutor recommends that the student should have

A given credit to the originator of JIT, the US

B how the idea was used by the market

C how it is developed in Japan

22. The student regrets that he had omitted

A the recent statements of JIT system

B the introductory definition of JIT

C the wide use of JIT

23. The data information found by the student is from

A a website(not technical)

B journal article (not useful)

C a textbook

24. The tutor thinks the system may not be useful because

A it might not be countable

B the content might not be in fashion

C unlikely to be accepted by the most important customers

25-30 搭配

What criticism has been given to each part of the students presentation?

A too informal

B too predictable

C too irregular

D too sudden

E too Technical

F too vague

- G too loosely related
H too unenthusiastic
25. delivery — C
26. purpose — F
27. transition — D
28. pictures — G
29. vocabulary: E
30. body language: H

例题 10

如何写学习日志 portfolio

单选 6+ 搭配 4

21-26 单选

21. What should be included in Mike's first Reflective Learning Module?

A the aim of this module

22. What can be shown that Mike is an effective communicator?

C listen to others

23. What can be done by Mike to improve his skill as an effective communicator?

B to lead a group discussion

24. What should be done to prove Mike is a critical learner?

B based on a range of sources

25. What does Mike feel after talking with Laura?

A he is looking forward to it

26. What should be mentioned in the learning portfolio?

A self-awareness

27-30 搭配

What reason does Laura give as using the following samples in the reflective journal?

27. essay — B (identify a problem)

28. exam — C (gain confidence)

29. class note — D (show independent learning)

30. presentation note — F (style of learning)

例题 11

论文讨论

配对 4+ 填空 3+ 多选 3

21-24 配对

A need more examples

- B too long
- C fully prepared
- D use existing overview version
- E not relevant
- 21. assignment introduction — C
- 22. body structure — D
- 23. methods technology — B
- 24. conclusion — A

25-27 填空题

- 25. Woman wants to set a listening task for presentation.
- 26. Man: speakers can be divided to discuss as a group.
- 27. Practice taking notes

28-30 多选

What should be put emphasis on presentation's conclusion?

- C chat room
- E improve computer skills
- F global access

例题 12

讨论辩论大纲

填空 3+ 选择 3+ 配对 4

21-26 单选

- 21. The girl choose to debate because
A ***
B it is placed even at secondary school
C after talking with her friend
- 22. What can they learn from the debate
practice their listening and speaking skill
- 23. How did Daniel and Fiona plan their debate ?
A collect all students' topic
B voting for either the girl or boy
C choose from a list themselves
- 24. Why divide into 2 teams ?
A everyone gets more chance to speak
B involve them into debate

C voting for either the girl or boy

25. What can be benefits as?

B less confident

26. What will lecturer to do after debate ?

A making comments on their writing

B ***

C writing an essay

27-30 搭配

A key point

B give handouts of articles

C writing on board

D give a demonstration

E ask for suggestions

27. procedure – A

28. body language – D

29. access resource – B

30. summary draft – C

例题 13

病假学生咨询作业

填空 10

21. The student has to send the project plan to the teacher as an email attachment. (The girl asks that is it okay to send an email the teachers agrees)

22. During some certain period, the work that group A&B has to do is to carry out the: data analysis.

23. The deadline of sending the project plan is : 5th November.

24. They're discussing the format of the assignment. The last stage of the work is: Individual Presentation.

Groups	Topics	Interviewee
Group 1	***	university 25. <u>Career Office</u>
Group 2	attitude to 26. <u>smoking</u>	***
Group 3	***	the university student Union and 27. <u>supermarket</u>
Group 4	28. <u>natural medicine</u>	***
Group 5	29. <u>student loan</u>	30. <u>Finance Office</u>

例题 14

讨论一项调查

单选 6+ 搭配 4

21-26 单选

21. The subjects in questionnaire / survey are

A tourist in the hotel in this area

B local resident

C people who earn living in the area

22. 调查怎么记录 result of questionnaire

A reply immediately/directly via electronic digital images

B drawing history building maps

C representation slides/ flit charts

23. What do the tutor think the presentation should be

A given by a group representative

B reported by all members in group

C written out on the flip chart

24 after the result of questionnaire

A divided into 2 parts to argue

B focused on interviewees' comment

C take into consideration of both sides

25. what do the two students feel the result of the project survey

A earn respect

B technology ***

C ***

26. How they show data to others

A there are too much information to absorb

B all the information are displayed

C some of information is confidential

27-30 搭配

A council meeting

B internet

C local newspaper

D national press journalist

E professional journals

F radio

G television

H community reference

27. maps — E

28. photos — C

29. not on budget — A

30. comments — F

例题 15	论文反馈	单选 6+ 搭配 4
-------	------	------------

21-26 单选

21. What is the teacher's advice on Tom's future draft?

A need to edit before handing in them

B use note form to help clarify (干扰选项, 听到了 note form, 但是不是 future draft, 是 last draft)

C make your own edition before submission

22. Why they only choose company O***** market (A / B 答案有争议)

A it is unusual compared with others

B not well know as other companies

23. What is the next suggested strategy?

changing way of advertising

24. (题干暂无回忆)

do more extensive research

25. (题干暂无回忆)

allocation of mark

26. (题干暂无回忆)

interaction with others

27-30 多选

27-28. What are the existing problems in reference?

B data in the book is not accurate

E the book is somewhat outdated

29-30. The tutor suggest 学生下次 presentation 时:

keep eyes on audience

time for handing following questions

例题 16

老师指导学生写研究报告

单选 6+ 搭配 4

21-26 单选

21. Benefit on completion of this program of report?

B help identify subject goal next semester

22. What is the suggest for the first draft?

download the template and revise some part

23. How did they choose course site?

A chose on e which is easy to access to

B selected carefully in a map

C randomly picked

24. What is the main aim of the field trip?

A just to apply feel techniques learned

B measuring a tree density

C son ingredient in the sand dune

25. What are the advantages including others' data?

A make data more reliable

26. Which method more simple?

A use an elevator to observe height of land

27-30 搭配

27. the equipment — *** (too complicated)

28. data collecting sheet — *** (not well organized)

29. reference material — *** (need a wider range of reference)

30. group talk with strangers — *** (repeat it next time)

例题 17

考古论文介绍

单选 5+ 搭配 5

21-25 单选

21. Which one is the most impressive ?

A volunteer

B professor' s attitude

C student's work

22. Fiona and Harry agree with

A the church

B rich man' s burial object

C ***

23. What does Harry worry about ?

A word limits

B too much material

C ***

24. What do they plan to do in the afternoon?

A make approaches to assignment

B visual materials

C ****subject

25. Which is the most confident part?

A subject matters

B presentation

C language skills

26-30 搭配

A good introduction of subject

B enjoyable to read

C full of illustration

D useful booklist

E too much details

F mistaken/inaccurate information

G miss some important information

26. Book 1 — F

27. Book 2 — A

28. Book 3 — D

29. Book 4 — G

30. Book 5 — ***

例题 18

学生讨论作业分工

单选 5+ 搭配 5

21-25 单选

21. What does Irey do recently ?

A she almost finished planning the experiment

B tired to catch up his lessons

C spend a long time in a lab

22. What's Bill's attitudes of Kim ?

A grateful to his contribution

B he is too stylish

C resent him for lack of lab work

23. Kim 顾着自己的 fiance, 导致

B not enough keep in touch

24. attitude to other members ?

A Jen thinks the man who is good at math is contributory

B may fail without input

C project nearly finished

25. Why Jen was invited to the project?

A she was popular

B she always reading her assignment

C close to the professor

26-30 搭配

A abstract

B acknowledgement

C methodology

D bibliography

E literature review

F results

G discussion

26. Irey — C

27. Kim — F

28. Jen — E

29. Bill — D

30. Lindia — G

工学专业 (建筑, 交通, 能源, 生产)

例题 1	师生讨论建筑材料 (3 人)	单选 6+ 分类 4
------	----------------	------------

21-26 单选

21. When soil is capturing carbon dioxide

B better in dry soil

22. benefit if concrete

C waste recycled

23. Hector's article ignored the problem of

A potential danger

24. What can reduce the harmful effect of xxx?

A specialized tool

25. Most interesting part of the Florida's research is that

B it combines two disciplines

26. 对 Hector 的研究建议

C introduce a new law

27-30 分类

A Hector

B Florida

C both of them

27. applied new radical research method — **C**

28. difficulty in reading makes readers more interested — **B**

29. problems remain unsolved in future — **A**

30. do more research — **A**

例题 2	讨论古城建筑研究结果	单选 4+ 多选 6
------	------------	------------

21-24 单选

21. Which part of the city surprises them the most?

A combination of nature and culture

B nature environment

C the government investment towards the city

22. Which part of the city disappoints them?

A They should have visited more museums

B The guide ...

C They wish to visit historical buildings

23. What should they do....

B adaption of old building

C more government investment

24. What do they think about the mode of Amsterdam?

A not suitable for others

B different from others

C unique...

25-30 多选 (五选二)

25-26 Which parts of their paper need improvement?

A They should combine the local history background

B ***

C ***

D ***

E ***

27-28 What they do to be more successful?

A They could visit a lot of places

B They could share their experiences with others

C They could do more research before the field trip

D They should have a tight timetable

E ***

29-30 ***

A Have more illustration(picture inserted in the paper)

B ***

C ***

D ***

E ***

例题 3	交通问题以及解决	单选 5+ 搭配 5
------	----------	------------

21-25 单选

21. According to John, the reasons for the Readlane's traffic jam is:

- A too less public transport
- B too massive growth of population
- C weak ability of repair transport

22. The river is posing a problem:

- A it increases the traveling time
- B it locates in the main area for business

23. What do the professor and John say about going to the south side park?

- A make a longer travelling time
- B it is not accessible by car
- C the parking fee there is cheaper than other area

24. What is the best part of the Victoria Bridge described?

- A the bridge is designed visually attractive
- B it is only used for public
- C this encourage people to choose public transport

25. The advantage of building a tunnel under the river will be:

- A make more people avoid traveling to the city center
- B congestion of the traffic will be greatly reduced
- C ***

26-30 搭配

- A described by John only
- B described by the professor only
- C described by both of them

26. Sometimes people will accept tolls which are necessary — B

27. People should know where their money spent into — C

例题 4	关于 SUV 的调查研究	单选 5+ 搭配 5
------	--------------	------------

SUVS(Sports Utility Vehicles):

- originally made for off-road driving(e.g. in remote areas)
- now widely used in 21. cities

Advantages:

- useful for 22. commercial purposes
- larger 23. engine Capacity
- suitable for towing large loads

Why popular in a wider market?

- because of their image
- seen as 24. safety by mothers
- larger seating capacity
- drivers prefer the 25. higher seats

Disadvantages:

- SUVs can be 26. harmful in urban centers because of their 27. weight
- bodywork doesn't crumple in an accident
- liable to 28. roll over easily

How to limit the use of SUVs:

- limit use to those people who need them(e.g. 29. farmers)
- raise cost of 30. insurance paid by SUV drivers

例题 5	讨论水下自行车	搭配 4+ 单选 6
------	---------	------------

21-24 搭配

Which is the following feature of each Autonomous Underwater Vehicle

- A can stay in one place underwater
- B has special shape
- C is made of strong materials
- D drive well on rough terrain
- E acts best in deep water
- F can sense dangers in seabed
- G uses solar energy

21. S83 — D

22. Sea Explorer — G

23. Wave Rider — B

24. T602 — F

25-30 单选

25. Which aspect do students agree that the study on AUVs should depend on?

A under-water condition

B budget

C data required

26. Where did scientist believe oil off Californian coast come from

A tanker

B on land vehicle

C fishing boat

27. What was the well-known Valin used for oil exploring ?

A it is most advanced at the time

B it can take photos of seabed

C it is specially designed for detecting underwater animals

28. What do researcher's use Valin to analyze?

A how long the oil was on the seabed

B how much was the oil

C the materials attached on the seabed

29. Why it is difficult defect the impact of oil study on sea animals

A oil is complex and unpredictable

B there are uncertain areas

C there are many different variety of sea animals

30. Why do researchers like to study oil seeps?

A it shows how sea animals change to suit environment

B it concentrates on one special area

C it doesn't require complex equipment

例题 6

讨论能源利用

单选 5+ 搭配 5

21-23 填空

Research About Different Energy-saving Innovations

Kites in Germany	in different 21. <u>weather</u> conditions, to reduce the emission of toxic gas
Vehicles in United States	22. <u>electricity</u> is the power
Oven in South Africa	are safer than...as less likely to 23. <u>explode</u>

24-25 多选 (5 选 2)

To select the interviewees to do the survey

A staffs on campus

B professors they are both too busy so they are not suitable

C local residence

D companies (干扰: the woman wants to ask the company but the man disagrees. In the end the man quits his idea because there were only about 5% respondent.)

E university students

26-30 单选

26. most people know little about renewable energy

27. windmill: should carefully choosing location

28. nuclear plants: a few people think they are unsafe

29. possible future of traditional resource: how to prevent pollution from traditional resource

30. new energy resource of Hydrogen: C benefits over weigh the high cost

例题 7	讨论澳大利亚风力发电	填空 10
------	------------	-------

21. in the past, wind powers was used to grind flour and pump water

22. the first wind power was used in carrying out research

23. the disadvantage of wind power:much noisy

24. blade sometimes harms birds

25. produce 50% electricity

26. a turbine is as large as a plane

27. most equipments are made in Europe

28. citizens were supported by subsidiary loan from government

29. when extreme condition weather appears, they can lower the speed

30. fan was made of fibre glass and timber

例题 8	讨论石油开发	填空 10
------	--------	-------

21-22 单选

21. What's the World Watch magazine mostly concerned about oil supplies?

A The huge amount of oil are used everyday

B The increasing dependence on oil-related products

C The length of time since the last new oil field production

22. Which of the following is true about the financial investor?

A they would like to move the money somewhere else

B they have confidence in the future of oil markets

C they are to blame for many current problems

23-25 搭配

A oil level in 1921

B reached a peak in 1991

C current level of oil

D adding water into oil

E price reached the peak

F world output reached a peak

G price reduction due to pressure

(答案待确认)

23. A

24. D

25. C

26-30 搭配

A history can solve the problems of oil supplies

B more oil are being supplied from existing oil fields

C we don't have enough time to find alternative

D the oils could be influenced

E oil supplied can be used for a long time in the future

F humans are already using the peak oil

26. **** — B (can be continued to produce oil)

27. Dr. Campell — D (it is already in the oil peak)

28. King Hubert — F (still have a long time to find alternative resources)

29. **** — E (impose the influence on stock market)

30. **** — C (it is too late to develop the alternative energy resources)

Oil level

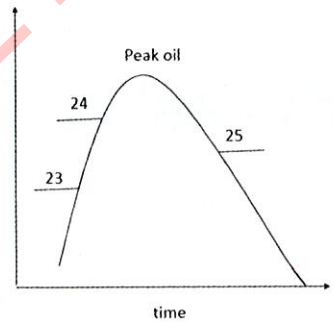

例题 9

制作牛仔裤

填空 10

21-26 填空

21. made in France

22. original pair of jeans

23. historical context

24. pocket attached

25. ***

26. always in fashion

27-30 搭配

27. History — (future growth)

28. Variety — (practical use)

29. Manufacture — (visual illustrations)

30. Marketing — (global aspects)

龙腾教育微信号; LTJY28888

管理学专业

例题 1	广告学：学生讨论潜意识广告	单选 4+ 搭配 6
------	---------------	------------

21-24 单项选择

21. Allen includes the interpretation for subliminal ads because

A it is frequently misunderstood

22. Why did the student includes James Jcacary

B the public has the interest in him

23. Allen believe that attitude of society towards subliminal Ad is

C the public has tolerance for it

24. What Allen think of one research on subliminal ads

A it has little scientific evidence for it

25-30 搭配

A pointless

B ***

C ***

D normally writing

E work in certain stores

F only for wealth people

G not convenient for people in a hurry

H some products may be damaged

25. Golden Zones — D

26. shop-in-shop — E

27. power Aisle — F

28. traffic builder — G

29. front-in-shop — H

30. posters and signs — A

例题 2

营销学：学生讨论运动鞋研究报告

单选 6+ 搭配 4

21-26 单选

21. How did they describe a website ?

A simple and clear to understand

B it is interesting

C be much relevant to their research topics

22. Which part is the most difficult one?

B the foot movement

23. What does the boy investigate

A download diagram from the internet

B take apart his old shoes

C borrow a sample from a tutor

24. About the report the job will be

A the woman finished half work of summary

B the woman finished most work of summary

C. the woman finished almost all work of summary

25. What they will do this weekend

A Answer the questions left by their professor

26. They will ask the tutor about

A where to borrow equipment (ppt, white board)

B How long the presentation will be

C who the audience are

27-30 搭配

A change the layout

B write it longer

C give a detail example

D change to other part

E in simple language

F write in the last part

27. introduction/summary — F

28. result — D

29. conclusion — E

30: discussion — C

例题 3

一家公司案例分析

单选 6+ 填空 4

21-26 单项选择

21. The tutor asks the man what was the initial problem when the organization was founded?

A didn't have a clear subjects

B no formal structure

C no perfect premises

22. What is the thing that the staff isn't satisfied with?

A their way of completing the task

B how work he started

C the work assignment

23. What is the problem of the manager there?

A He had a lot of tasks to do

B does things for his own profits

C made so many decisions himself

24. What do the staffs think about the new manager of this organization?

A They are delighted to see that the meeting time is shorter

B They feel annoyed towards him

C They are amazed that he has done it well

25. What achievement does the organization make?

A children are involved to help

B There was no particular achievement

C it built a local primary school

26. The problem is solved

A ***

B when one administrative quits

C ***

27-30 句子填空

27. focus on the problems in employment and role of motivation

the tutor suggests her reading some books useful about 28. culture or 29. changes of the management

30. the tutor suggest to read an article about nature of volunteering

例题 4

营销管理：老师和两名学生讨论即时餐 (3 人)

单选 5+ 搭配 5

21-25 单选

21. Slister and Betty decided to work together because

A they need a lot of research

B they had previous experience to work together

C they separate the topic

22. The first piece of interview they will do would be

A shoppers of the supermarket (原文 : customers)

B manager from the supermarket

C manufacturers of the supermarket

23. The interviewee most concern about

A the food additives

B the weight problem

C the cost of the food (原文 : price)

24. The interviewed are surprised by the label because

A too much detailed information

B high salt level

C so many food ingredient

25. Slister's most concern is

A not enough statistics

B missing the deadline (原文 : don't have enough time)

C lack of analysis

26-30 搭配

A do it together

B it is not worthy to do it

C do it first because it is easier

D find some one else to do it

E do it later

F need special training to do it

G need more information before do it

26. providing the transcription of the interview — A

27. providing the analysis of the statistics — D

28. analyzing the ingredients — B

29. questioning the people when they are shopping — G

30. using audio recordings in presentation — E

例题 5

旅游管理：热门旅游地点调查报告

单选 6+ 搭配 4

21-26 单选

21. The area refers to?

A geographical locations

B tourist sites

C ***

22. What does “Culture” mean by the female in the discussion?

A Long established places

B ***

C ***

23. Why there are 200 surveys?

A a wide range of surveys

B meet the deadline

C get valid results

24. What groups of people they interview?

A local residents and international tourists

B local tourists and international residents

C international and local tourists

25. What concerns do they have about asking people

A age

B occupation

C ***

26. Which form to show the results?

A line graph

B pie chart

C table

27-30 搭配

Which tourist attractions are highlighted in these countries?

27. Mexico — *** (food festival)

28. Greece — *** (ancient buildings)

29. Britain — *** (theater performances)

30. India — *** (traditional dances)

例题 6

人力资源管理: 招聘

单选 5+ 搭配 5

21-26 多选 (5 选 2)

21-22. What should the secondary school graduates put emphasis on?

motivation

desire to learn (enthusiasm)

23-24. Why is it difficult for re-employment for women when a child of her is born?

lack confidence

had little time to work

25-26. Companies are unwilling to employ the people who are?

sacked from the former job

unemployed for a long time

27-29 多选 (7 选 3)

Why do companies are unwilling to employ the retired worker?

their professionals are outdated

hard to train them again

much aged

30 句子填空

30. clothes

教育学专业

例题 1	教育系学生讨论选择课堂实验	搭配 6+ 图表 (设备选择) 4
------	---------------	-------------------

21-26 搭配

A very boring

B too difficult

C easy to understand

D need special equipment

E cheap

F immediate result G good math practice

H take longer than usual to do

21. course of steam engine — B (too difficult)

22. breakfast cereal — E (not too expensive)

23. bounce balls — C (help math)

24. paper making — A

25. tie water experiment — H (time-consuming)

26. extract glue from milk — F

27-30 图表 (设备选择)

27. metal container - F (tank)

28. integral refiner - D

29. drip tip - B

30. pottery container - C

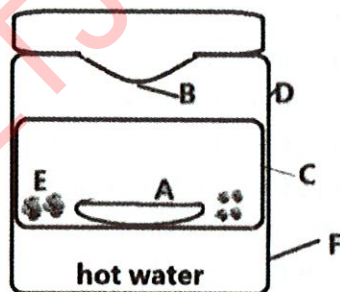

例题 2	儿童语言学习调查研究讨论	单选 6+ 多选 4
------	--------------	------------

21-26 单选

21. The research report was based on

A special built house

B installed record equipment in room

C technician live in home

22. Ben is not sure about the methodology because
the child
A too young
B moral aspect as without the child permission
C related to the researcher
23. Which part of the experiment conclusion does Ben questioned ?
A children are too young to make record
B it is valid in all cultures
C parents' simplified language is effective in a long run
24. What does the computer can be used?
C make speech and behaviors analysis
25. What does Milteda's most effective way of learning French?
A make grammar into context
B he is a confident speaker
C learn words and phrases using in daily life
26. Why does Ben like to learn dialogue by role play?
A ***
B the written words and phrase can be used
C because Ben is confident in speaking
- 27-30 多选
- 27-28. 他们会使用的研究方法是
A experimental
B video interview
C dairy
D questionnaire
E observation
- 29-30. Ben 在上次调查中的问题
A technical error
B missed appointment
C broken facilities
D the data cannot be used
E interruption

例题 3	音乐和数学的关系 (教育系学生)	单选 6+ 搭配 4
------	------------------	------------

21-26 单选

21. The two students agreed that the purpose of the presentation is

A to show the relevance of the topic

22 The similarities between music and math s their

C counting

23. They need to add _____ in their presentation

B surprising elements

24. They want to find out

A whether music can help math

25. The purpose of Blacksmith is to

C ***

26. They need to do further study on

C ***

27-30 搭配

27 B (musical instrument, too much time)

28 C (playing clapping games, too easy)

29 F (film of piano)

30 A (different music, make audience confused)

例题 4	非洲部落调查研究	单选 6+ 填空 4
------	----------	------------

21. DOGON tribe can recognize different stars astrology by

A the location of stars

B effects among stars

C the distance between two stars

22. How do WYAKA people get rich

A open bank account

B assist others

C lend money to others

23. How docs the tribe preserve local habitat

B land use

24. another tribe ***

C go back to former environment

25. the professor supports the *** by

A using the subway

B camel transportation

C using the steam train

26. N*** tribe

C they have difficulties to trade minerals

Tribes	***	Focus on activity
DOGON	***	They know 27. <u>sharing</u> is very important
WEYAKA	***	to promote Government's education 28. <u>plan</u>
P***	encouraging others to 29. <u>settle</u> in the area	***
N***	***	the valuable of different 30. <u>gifts</u>

例题 5	毛利语言的学习和保护	单选 5+ 填空 5
------	------------	------------

21-24 单选

21. Compared with other languages, what are the difficulties of pacific language preserving?

A reason is complicated

B language is more endangered

C too less study on them

22. Saving language measures to be taken firstly?

A put more attention

B to raise money

C offer new shelter

23. Pacific language users' attitude towards outside language?

A very cautious

24. Which area preserve the language best?

A Hawaii

B Romulo (a place begins with R)

C Polynesia

25-30 搭配

A newspaper

B universities

C parliament

D school

E books

F television

G radio

H court

25. no money — E

26. permit — C

27. the third language — B

28. first study diploma — D

29. radio broadcast — G

30. after few years — F

理学专业 (生物,地理,环境,计算机)

例题 1	鸟类观察作业	填空 6+ 分类 4
------	--------	------------

21-23 表格填空

requirement for experimental project

21. quantities: small scale

22. cost within budget

23. birds are feed on: seeds, fruits and nuts

24-25 句子填空

24. inside the observation area, position of table in each garden: underneath a tree

25. birds daily observe time: 5 minutes

26-30 分类

A these will be done by themselves

B these will be done by observers

C these will not be included in the form

26. date recorded by — A

27. types of birds by — A

28. bird's food by — B

29. bird's photo by — B

30. comments by — B

例题 2	讨论地质考察计划	填空 10
------	----------	-------

21. job responsibilities: interview with tourists

22. see environmental damages

23. famers did too much farming, so that the environment has been destroyed

24. the area covers 21,000 square Kilometers

25. "Growing area "is about 10.50 km

26. sample

27. on site measurement of the soil

28. interview rangers
29. study photographs to check the changes
30. borrow map from local faculty to do the presentation

例题 3

学生讨论环境保护调查

单选 6 + 多选 4

21-26 单选

21. What do students say about environmental practice ?

A they are very well-known

B won an award

C student can find information on website

22. What makes students most surprise about the statistics?

A lots of energy

B there are too many new building

C there are too many new students

23. What's the main problem of recycling bin?

A they are not used property

B solar power will not last long

C there are not enough computers

24. Which one has the most effect?

A turn appliance off

B solar power couldn't last long enough

C covered windows

25-26 多选 (五选二)

Which TWO things are the students most focus on?

A how efficient the process of making bottled water

B how many empty bottled water

C how much they consume

D how much water consumed

E how much bottled water been thrown away

27-28 多选 (五选二)

Which TWO types of transport are more effective?

A widen the pedestrian paths

B build up the bridge

- C power of machine doesn't last
 D they are not enough
 E cannot carry enough people

例题 4

鸽子保护调查研究

选择 5+ 配对 5

21-25 单选

21. 城市有人们喂 pigeon 导致什么? 说鸽子在一些国家城市非常多, 然后城市人们喂他们会导致什么问题啦, 政府如何处理鸽子的问题啦之类的 (A/B 有争议)

A****successful 喂养是让他们更多繁殖 (因为他们不用花时间找食物了于是生一堆)

B pigeons become overweight

C pigeons get sick/Unhealthy people feed them junk food instead of . . . made by themselves

22. most effective measure Government Melbourne's for protecting pigeon the

A Move habitation of pigeons out of city

B provide soaring space

C build homes/nests best method was to make rooms in which pigeons can live

23. 觉得新政策 How is the Second Stage (答案暂无回忆)

A 政府的花销太多

B cruel

C ineffective the boy said it spent a lot on . . . high price

24. 对某个地区的鸽子 which is successful 成功的对策

A ***** NOT benefit

B education for people

25. 两个人还要做什么研究 in next(will do)

B affect human health 的已终做了 damage building 的 research, 女孩做 ** 的 research,

26-30 搭配

A eat meat

B endangered

C in a variety locations

D eat a particular plant

E sing for mating 伴侣

F communicate with wings

G avoids Grounds

H bright color

26. Australia crest pigeon — F
 27. rook pigeon— C 数量非常少 ,rock
 28. black-banded pigeon — G 住在 high trees
 29. Gala*** pigeon — D cannot eat any meat, it will poison them sothey eat a leaves from a certain tree
 30. N*** pigeon—H has attractive color, green
 (选项字母顺序不确定)

例题 5	学生向老师请教生物课程	填空 10
------	-------------	-------

	subjects focus on	something need to do	feasibility(judged by the woman)
biological rhythm	sleep's 21. <u>habits</u>	complete 22. <u>chart</u>	not enough 23. <u>time</u>
blood pressure	heart disease	problems with 24. <u>diet</u>	school stadium has not enough 25. <u>space</u>
stress level	stress of different social group (economic group)	compare with 26. <u>students</u>	use school gym don't incur extra cost, but it was 27. <u>closed</u>
***	main 28. <u>causes</u>	conduct students with a surprising 29. <u>test</u>	data has not be 30. <u>clear</u> enough

心理学专业

例题 1

音乐和心理关系

单选 4+ 搭配 6

21-24 单选

21 The tutor likes the topic because

B other students will be interested in the topic
(could spark discussion among students)

22. When interviewees listen to the songs of the teenager years music, and ask

B whom the songs remind you of

23. The research is the first to

A include so many participants

(its the scale of it that impresses me, 64000 respondents from the world is involved in the research)

24. Sarah doubts the finding because

C its data may be unreliable (I'm skeptical about the data, don't trust it)

25-30 搭配

A information is inaccurate

B respondents are not interested (too dull)

C too detailed (too many facts)

D incomplete statistics

E needs more expert opinion (listen more to other scholars)

F make it more relevant (link better)

G not fit for every one

25. background research — C26. other similar research — B27. research topic: — G28. market research — D29. presentation — E30. future research — F

例题 2	音乐对于进食影响原因	单选 4+ 多选 2+ 配对 4
------	------------	------------------

21-24 单选

21. research subject

A music's effect on guests

B music's effect on food

22. In XXX café, music is played:

A In different areas

B uniform level volume

C certain time

23. purpose of questionnaire

C disguise the purpose of the survey

24. Questions are collected from

A a previous study

B self made

C the dictionary

25-26 多选

A competitor nearby

E seat capacity

27-30. 搭配

27. jazz music — *** (people spent more money)

28. no music — A (people think the restaurant is overpriced)

29. classical music — *** (people left right after eating)

20. pop music — *** (people will come back again)

例题 3	目击者的可靠性研究	单选 6+ 配对 4
------	-----------	------------

21-26 单选

21. Why do people think witness is more reliable?

A who are respected in the community

B witness has confidence

C complicated language

22. What is the problem with the book?

A no specific conclusion of

B too few people as samples

C data is collected long time ago

23. Both of them agree about the validity of evidence, the most important

A less weak vision light

B how event lasts

C not at a long distance

24. Which one is true for Native observer?

A have no record of police investigation

B don't think they have witnessed a crime

C person who is not involved in an accident

25. Why did they fail to change the wrong testimony?

A afraid of being looked foolish

B afraid of getting trouble in law consequence

26. fail to ... authority

A witnesses cannot link the photographs and the situation well

B fail to compare the reality with the subjective idea

27-30 搭配

27. radar— *** (afraid in an unfamiliar environment)

28. open questions — D (confused by testimony)

29. closure enquiry — *** (children cannot tell the truth and lie)

30. *** — B (distrust the interview)

例题 4	艺术对病人的影响	单选 4+ 配对 6
------	----------	------------

21-24 单选

21. previous hospital put the art and music focused on

A children

B patient who have psychological problems

C medical staffs in the hospital

22. What the response from the staff when the arts was used as medical tool?

Firstly the staff dislike it

23. Why not let patients themselves turn on the music?

impractical

24. Woman's attitude of the new hospital?

surprised it is less convenient for staff

25-30 搭配

A Patients spend less time in the hospital

B patients who are more cooperative

C art and music have little impact on the patients

D patients who concern more on details

E patients whose blood pressure and heart beat rate are average

F patients who ask for less medication

G visual arts have more impact on the patients

艺术对病人的影响诊所的病人特征

25. postnatal clinic — B

26. trauma and dissociation — C

27. day surgery clinic — E

28. children's clinic — A

29. emergency — F

30. gynecology clinic — G

文 / 艺专业 (文学, 艺术)

例题 1	作家 Christie	单选 6 + 搭配 4
------	-------------	-------------

21-26 单选

21. What are Christie and William Shakespeare in common ?

A ignored by critics

B appeal to the public (very popular)

C influential

22. What surprise Olive most when she read Christie's book ?

A plots in a slow pace

B in simple words (very straightforward)

C theoretical dialogue

23. What does student say about Christie's biography ?

A She always keeps a traditional way of thinking

24. What does student say about Christie's novel turns into film ?

A films exactly originated from the book

25. What do students agree in terms of Christie's marriage ?

A Her husband envied about her success

B She's always separated with his husband

C Her husband's works have inspired her (he's an architect and she traveled with him all the time which gives her a lot of experience, lessons learned.)

26. What does all Olivia say about a journalists' comments on Christie?

A amused by stories a lot (very entertaining, good jokes, soldiers)

B impressive details

C ***

27-30 搭配

A the budget is limited

B adapted to local audience

C too complicated

D well research

E varied in quality

F people not surprised at all

27. The performance script B

28. The design of stage-set F

29. The lighting C

30. The costume D

例题 2

尼日利亚的非洲艺术

单选 6 + 多选 4

21-24 单选

21. what makes the man become interested in sculpture ?

A ***

B an exhibition about sculpture

C ***

22. What will be the focus of his presentation?

A ***

B ***

C people

23. What finance his trip to Nigeria?

A a grant from an art organization

B ***

C ***

24. The most impressive thing during the trip

A ***

B meeting a professor in the field

C ***

25-30 多选

25-26. What will the man add to his presentation about sculpture

A enlarged images about sculpture

D the sculpture making techniques of local people

27-28. ***

C religious belief of local people

E the activities for the past thousands of years

29-30. What will the man tell the audience about his trip to Nigeria ?

B the people who made the original sculpture

E the initial discovery of the local sculpture

龙腾教育微信号; LTJY28888

实习反馈

例题 1	公司实习总结	搭配 4+ 填空 6
------	--------	------------

21-24 搭配

21. B (she has contacted there)
 22. B (people are friendly to her)
 23. B (they have time to deal with relationships)
 24. A (figure out the purpose of internship)

25-30 填空

25. speak to a former worker who worker there
 26. talk to professor about problems
 27. talk to chief executive to get feedback
 28. ***
 29. if you have a bad mood, talk to department manager
 30. talk to group organizer

例题 2	翻译实习总结	单选 6+ 搭配 4
------	--------	------------

21-26 单选

21. Tom feels to translation on social event
 A confident about no error
B nervous about speaking in front a group of people
 C proud of responsibility
22. What's impressed Tom and Lisa most?
 A actors and crew members coordination
B much attention on details in performance
 C ***
23. They felt some of the mistakes could be avoided if
 A the director came on time
B the director presented earlier
 C the director presented later

24. Lisa was surprised By the
 A extra time she didn' t need
 B time was left after work
 C less free time
25. Lisa thought the problem of the English subtitle was
 A too small to read
 B hard to understand
 C inaccurate to express idea
26. What part did both of them feel disappointed?

B a few audience

27-30 搭配

A too expensive

B too controversial

C too long

D too superficial

E very specific

F very practical

27. guidebook — F

28. *** — C (take a whole summer)

29. *** — B

30. *** — D

例题 3

实习反馈

搭配 6+ 单选 4

21-26 搭配

A Julie

B Mike

C Both Julie and Mike

21. company expect me early, too much on — A

22. get along with the journalists — A

23. interview gain value — C

24. excited on publication — C

25. information from enquiry on journalist, useful — B

26. knowledge learned 是否在实际工作上有效 — A

27-30 单选

27. What Julie learned from interview?

C not simply read question out

28. What Mike learned from business journalism?

A the scientific term

B the informality / informative format

C how difficult to develop target market

29. How Julie worked website problem?

A difficult to log into

B too much childish words

C too difficult to speak

30. How does Mike judges Julie's work on website

A It' s an ideal job for Julie

B Mike is interested in that job

C Many young people can do that job

例题 4

酒店实习反馈

搭配 6+ 单选 4

21-26 搭配

A it needs patience

B it is very strict

C the daily routine of hotel

D it is short of staff

E it is noisy

F it is very tiring

21. the reception — C

22. the restaurant — B

23. the coffee bar — D

24. the shop — F

25. the personnel office — A

26. the cleaning — E

27-30 单选

27. What does the experience benefit Mona?

A good for her future job

- B good for her dissertation
 C let her know something of the specific job
28. Why the tutor wants Mona to do the presentation?
 A she can do it skillfully
 B she want to do herself
 C she can show other students how to do a presentation
29. What does Mona suggest Tom to do?
 A go and talk with the career organization in the university
 B talk to his tutor
 C contact the manager of the hotel
30. What's Tom's plan for his own essay?
 A about the rise of five-star hotel
 B about the video use in the hotel
 C how hotel develop itself

例题 5	酒店实习反馈	搭配 6+ 多选 4
------	--------	------------

21-26 搭配

- A frustrated
 B challenging
 C enjoyable
 D easy

21. hotel accommodation booking — D (in most cases the hotel is fully booked but he would always find a solution to that)
 22. tour on company premises — B (it is not easy but he could do it well)
 23. leisure activities — C (the man said he really loves to do it)
 24. ordering food is outsourced — B
 25. airport transfer — D (it's easy, they have already outsourced this and there would be specialized company which would come to help them to do this)
 26. information technology problem — A (he was frustrated in a very obvious way, but he couldn't compliant anything)

27-28 多选 (五选二)

- What does the boss think of Alex?
 A intelligent (bright)

B good at organization

C good proposal of recommendations

D need more training

E *****

29-30 多选 (五选二)

What area does Alex think should be improved?

plan phone calls (didn't arrange well)

be more decisive (make decision more quickly)

speaking French

working to deadline

Section

4

LTJY28888

龙腾教育微信

龙腾教育微信号; LTJY28888

动物研究

例题 1	非洲企鹅	填空 10
------	------	-------

Penguins in Africa

31. penguins need to control the temperature of the body
32. drift land movement from dawn to dusk
33. penguins live in the holes of the trees./They like to use the tree roots.
34. like a plane, yet the flying speed is limited because of their heavy bones.
35. lose their weight in winter
36. annual Molt feathers in most three weeks
37. human activities poses a threat : industry and pollution

Predator

38. competition for live and for food with seals and sharks
39. seagulls eat penguin's chicks and eggs
40. to maintain the gene diversity for penguins is important

例题 2	白野猪和红鹿	填空 10
------	--------	-------

31. boar is not a protected species of wild animal
32. 控制它的数量因为 they damage the environment
33. and they spread diseases
34. law prohibited using: poison
35. kept deeding them in the forest
36. increasing population density
37. 三个名词 ***,** and potatoes
38. come out in the winter cause the food is scare
39. keeps number of deer for hunting
40. deer will destroy farmers' crops

例题 3	澳大利红火蚁	填空 10
------	--------	-------

31. desert
32. soil
33. port
34. rocks
35. dogs
36. water
37. helicopter
38. corn
39. support
40. local

例题 4	动物冬眠	填空 10
------	------	-------

31. resources
32. evaporation
33. light
34. mud
35. reduction
36. nest
37. stressful
38. heart
39. starvation
40. competition

例题 5	海豚	填空 10
------	----	-------

31. live in water which is clean
32. weather: the impact of climate change on coastal dolphins is difficult to ascertain, however, predicted sea level rise and increases in water temperature and acidification
33. human activities can contribute to population declines
34. dolphins communicate with whistle
35. colour of the fins
36. ideal environment

- 37. in Australia, inshore nets, entanglement in shark nets
- 38. hunting is not allowed in some areas
- 39. water pollution
- 40. noise disturbances

例题 6

濒危动物

填空 10

Recent problems in Australia

- several species of 31. frog lost habitat because of human activities
- loss of food source due to pesticides is affecting many animals, especially 32. birds
- single growth crop plant, for example, 33. corn is not beneficial for animals

Human ignore protecting animals

- protection is influenced by opinions on support from 34. media
- concern smaller animals, e.g. 35. insects
- with shock or 36. fear
- as our rivals in terms of 37. food

Reasons for preventing extinction

- ecosystem need to be 38. complex to keep stable
- disorders of 39. blood system
- some 40. plants can be used as indicator for environment change

例题 7

英国鸕鹚 (bittern) 的保护

填空 10

male bittern make distinctive 31. sound in spring for mate

10-15th Century

people take the birds as a luxury 32. food

16th Century

more demand from collectors for house 33. decoration

17th Century

wetland habitat ruined for 34. agriculture and construction expansion.

Research Finding

global warming cause the 35. damage of their habitat

rising tides water mixed with 36. salt

current focus on 37. fish number, food sources in reeds

nowadays, natural reserves are all too 38. small

pollution such as 39. chemicals

Conclusion

reservation can reduce the number going further down but still at 40. risk

C eyesight

例题 8

动物语言功能

选择 5+ 填空 5

36-40 单选

31. Experiment or research is ?

A exciting

B unconvincing

C surprising

32. Ape experiment show problem is ?

A they are always hungry

B helped by computer

C they do not provide real language

33. people wouldn't accept animals can communicate believe A ***

B lack of reasoning ability and don't know the next idea

C ***

34. What do people tend to use sight to measure the intelligence of animals?

A thinking based on experience

B sight vision

C sense of acute ***

35. Rat is better on ?

A smell

B color

C eyesight

36-40 填空

36. Horse can use land marks to find way to home.

37. Sheep can recognize faces of human.

38. birds can share with human with their good eyesight.

39. People regard animals as machines or robots.

40. In future for animal, people should pay

more attention on what they do well.

例题 9

非洲鳄鱼

填空 10

31-35 单选

31. She doesn't believe that there is crocodile, because

C no scientific back up/support (She hasn't seen evidence in any document there is no science evidence.)

32. The group size is?

A 20

B 36

C 45

(He Said scientist estimated that max mum s 36, then said common size was 20. Somebody thought this number would double. But he doesn't agree with that.)

33. Where the crocodile live in?

A vegetation (where has been vegetable and plants)

34. Crocodiles live in caves of?

C Underground

35. In the past, what happened in the north Africa?

B Wetland become desert

(crocodiles did not change where they've, the original place converted into desert. So they now live somewhere near water, mostly in the cave. 鳄鱼没有改变居地, 原不住的地方变成了沙漠, 但他们现在住在离水近的地方。)

36-40 填空

Information about Wetland

36. 8 months

37. The depth of ***

38. Local people don't fear of crocodiles

39. No evidence of being attacked by crocodile.

40. Researchers still want to find more information about population size, migration patterns, and relations to other population.

例题 10	美国盐沼的软骨鱼	填空 4+ 单选 4+ 填空 2
-------	----------	------------------

31-34 填空

31. Salt contents as high as ocean
 32. Sea levels depth and warmth of water
 33. In the sea, worms and shrimps eat plants for survival
 34. the marsh land are used to plant rice cultivation

35-38 单选

35. A. the erosion of soil
 36. B the place which is “less walked” misses something
 37. This marsh park was used as a place
 A ***

B one' s residential purpose

C nostalgia tour / remembering the past

38. it is difficult to control:

A water level is too high

B the density in the water

C protect *** from being extinct

39-40 填空

39. Batoidei often be fed on shellfish(es)
 40. Time of year of the female laid eggs is spring

例题 11	非洲青蛙	填空 10
-------	------	-------

Description

frog's skin is 31. smooth

skin is firm for 32. protection

male is 33. half the size of female frog

Habitat

Frogs live in 34. mud

The eat alive of dead creatures and they prefer 35. still water.

They live in the condition with high level of 36. salt.

Diet

They use sense of 37. smell, fingers to capture goods

They use their front leg and 38. lateral-line system

More Information

People in US keep them as 39. pests

It has 40. antiseptic property

例题 12	大象	填空 10
-------	----	-------

Elephant

· record of their date of birth and also their 31. mothers

Findings

· social system has many 32. layers

Corporation

· two elephants get the food using 33. rope

Flexibility

· some elephants move to a new area because theres lack of 34. rain

Emotions

· move 35. bones of another elephant after death

Intelligence

- their brain 36. weight is high in comparison with that of their body
- how they 37. walk obvious change
- older male makes a better partner; older female recognize 38. danger
- how they smell-difficult to study in the 39. wild
- how 40. sensitive one to another

例题 13	红海胆	填空 10
-------	-----	-------

feeds on 31. plants

covered in 32. spines that protect it

regarded to be 33. pest

34. Asia was important market

scientific interest*****because of the 35. decline in urchin population

no evidence of 36. aging

maximum of life span: up to 37. 200 years old

after 22 years old, grow 38. 0.1cm per year

can still 39. breed and grow

the growth is unconnected to 40. ocean conditions and other external factors

例题 14	两栖动物	填空 10
-------	------	-------

Research Background:

31. conservation scheme

32. closed to the base of the food chain

33. unborn babies eat others to survive

34. the male carries the eggs

35. loses energy

Experiment about other species:

*** Toad

36. pollution of breeding habitat

37. agriculture development

*** Frog

*** Toad

Barriers:

live in 38. mountains

39. sea

*** Frog

Suffer from 40. diseases

例题 15	海马	填空 10
-------	----	-------

Habitat

the species can be found in 31. shallow waters

they are most likely to be found resting in beds of 32. seagrass or coral reefs

Description of the body

a thin 33. skin covering a series of bony plates in rings

they have an armor-like body composed of bony 34. plates (approximately fifty) form the outer skeleton of the species.

the seahorses head part looks like a 35. crown bony crest called a coronet located on the backside of their head at the edge of the skull

Diet

seahorses feed mainly on brine 36. shrimp on minute crustaceans

male caring for the eggs and giving 37. birth the males have a brood organ into which the female places her eggs

their colors change due to diet, level of anxiety or 38. stress, and/or mood, altercations in their environment

Threats

endangered by over 39. fishing and habitat destruction.

(Seahorses also are used in Traditional Chinese Medicine. Seahorse populations are thought to have been endangered in recent years by over fishing and habitat destruction.)

40. disease. (There are many parasites and infections known to affect the seahorse.)

例题 16

蜗牛和鼻涕虫

填空 10

31. They live in the environment which is similar to the sea.
32. Their pattern on their shells is generally to the right.
33. Some gastropods even have hair on their shell.
34. Their diet is mainly made up of worms.
35. They are introduced to the country as food in the 1st Century.
36. They have some unique defense system.
37. The environment that is most dangerous for them is dry area
38. They live in old forest and swamp.
39. Some prefer to live in the underground.
40. They are good indicators of the standard of the environment.

文化研究

例题 1	摄影	填空 10
------	----	-------

31. photographs used to be very expensive
32. the photographer is not an artist but specialized in painting
33. to be realistic
34. reduced in books
35. the frenchman use a camera to make the first enlargement
36. old buildings
37. locate outside the studio not beside the door
38. according to the layout of the cities
39. it was regarded as a science
40. the material is made of glass

例题 2	语言研究	填空 10
------	------	-------

31. Lingua Franca need to know the background of an existing language
32. the language itself can promote the global commerce
33. the grammar is standard
34. one example people familiar is Greek
35. Pidget was created by children
36. it has many limitations
37. Russnorsk is a mixture of 2 different languages
38. Creole is an entirely invented new language
39. the language is very advanced compels
40. it has a lot of rare vocabulary

例题 3

铅笔书写的历史

填空 10

History Background

31. product design is often the result of evolution
32. Greeks and Romans wrote with bone
33. Chinese invented ink
34. in the west, pens made with feathers were used for 1000 years

Development Process

35. at first, the graphite was wrapped in string
36. for marketing, people gave a popular name for their pencils to promote loyalty

Modern Manufacturing Process

37. the graphite is made into powder combined with clay
38. make it hard to be suitable for writing
39. dipped in wax for smooth writing
40. the wood is heated to removed oil

例题 4

日本石器时代

填空 10

31. Research found evidence of Jomon's existence in Japan before 10,000 BC. The people who lived there at this time are regarded as Japanese ancestors.
32. Jomon people arrived in Japan before the end of the era of ice age through a land bridge, which links Japan to Asia's mainland.
33. Temperature rise led to the growth of forest and population.
34. As a result of global warming, rising sea levels also changed Jomon people's migration to other areas.
35. Their major food pattern consists of nuts and fish.
36. They were hunter gatherers whose weapons are arrows and spears.
37. They lived in round buildings in a village.
38. The people used to use pairs of stone in cooking.
39. Tradition of local marriage ceremony has been well preserved till today.
40. Pottery making is a revolutionary technology. And later they learn how to grow rice.

例题 5

极限运动

填空 10

Ancient History

- Extreme sports is a kind of 31. lifestyle sports

19th Century

- a team sport was created for 33. company workers
- 34. golf in higher social class

21st Century

- people didn't like 35. traditional sports
- reason 1 : restricted 36. regulations
- reason 2 : regular 37. training
- help them confront to 38. fear

Future

- young people think that government should provide more 39. entertainment instead of individual competition.
- sense of 40. community

例题 6	流行音乐历史	填空 10
------	--------	-------

31. in the 19th and 20th century, American people work in factories.
32. culture influences by different immigrations.
33. sales profit is affected by several factors, the most important one - quality is more important than quantity.
34. strong spread from churches
35. different music but the common language
36. an industry of goods and services : creating new jobs e.g. publisher
37. performers are firstly separated from audience
38. now middle class began to be interested in music
39. develop a system for composing music
40. youth culture

例题 7	语言消失	填空 10
------	------	-------

31. need a lot enough materials
32. 有一种文字 writing word in clay tablet was the oldest
33. according to the context of words 根据上下文推断出意思
34. samples
35. 有些文字出现在 monuments

36. Italian and Greek were written in a different direction
37. writing word in clay tablet was the oldest
38. form for circles
39. it was type of printing
40. served as a game or puzzle...

例题 8

巴西国家土著公园地图

填空 5+ 单选 5

31-35 填空

31. map covers the areas of: 39000 hectares
32. this rain forest is the: world's biggest national park
33. cooperation from: government, scientists and help from local tribes
34. they applied the GPRS data, local knowledge and aerial photographs
35. some places are unmarked, besides forest, the plants used for medicine to grow

36-40 选择

36. this map outcome will be the first and most important step in
- C. protect the local and world forest land
37. another result can be:
- A. develop the community
38. map can be used to educate children
- B. local history
39. the problem when making the map
- A. language barriers
- B. they can not understand land mark
- C. isolated by different way of thinking
40. Finally the most important success is, it's beneficial
- A. we won local people' s contribution

例题 9

13 世界英国的田园生活

填空 7+ 单选 3

31-37 填空

Research resources come from:

- get materials from 31. museum archives
- internet

- a 32. map found by librarian in library
- 33. surrounded by ditch for protection
- 34. advantage : increase production of peas and beans which fertilize the soil
- 35. local wealthy people like to buy porcelain and delicacies from shops at the local place
- 36. guarded against birds from attacking crops

37-40 单选

37. How about a new farming method (mix farming)

A it helps reserve the land

B it has impact to cattle work in the field

C weather should be focused

38. Deep plough has the function of changing

A something about the seeds

B the use of animal pulling the plough

C the shape of the farmland and soil appearance

39. what about the new innovative windmills

B people can adjust the fan to face the wind

40. Why poor people/ small household has higher production?

C free farmers have enough labour

例题 10

澳洲公路发展

填空 10

- 31. in 1940s, 60% of users used public transport
- 32. the road used to be crowded and uncomfortable
- 33. in 1940s, car was associated with freedom
- 34. there are 5 disadvantages of cars, the last one is high tax on cars
- 35. more motorists until new government election in 1949
- 36. Driving affects relationships between people
- 37. in 1970s, driving affects road condition: roads are jammed and polluted
- 38. there are fewer *** but more in 1980s and 1990s, more lanes and road directions appeared
- 39. in this field, it is different from the past: the design of advertisements to attract motorists
- 40. since the creation of the shopping mall

例题 11

时间测量的历史

填空 7+ 单选 3

31. the sun's position
 32. animals' behavior
 33. years later, precise measurement became important for organizing activities for religions
 34. connected with government
 35. the earliest ancient time keepers were discovered in Mesopotamia and North Africa

the sundial	it was noticed that the length of the day 36. <u>varies</u> at different times of the year
the clepsydra (water clock)	it was more reliable, because the water flow still depended on the variation of 37. <u>pressure</u> and <u>temperature</u>
38. <u>sandglasses</u>	the time of 39. <u>duration</u> was limited
candle	candles 40. <u>disappear</u> the rate of <u>burning time</u> is subject to the candle wax

例题 12

新西兰艺术家

填空 10

31. painting
 32. materials such as glasses and plastic
 33. shells
 34. made of electronic items, e.g. light bulbs
 35. displayed his photographs of light bulbs in the museum
 36. pencil
 37. movies
 38. his long-term interests in travel
 39. sense of humor
 40. he expenses that feeling of loss, being lost

例题 13

著名摄影师

填空 10

31. Why does the speaker choose to do research on this photographer?

A famous

B he took many well-know photos of New York

C for his work experience

32. What makes this photographers different from others

A they demonstrate the reality of the city

33. Why did he leave LIFE magazine

B he wanted to publish his ideas and works

34-36 搭配

34. 1955 — E (the exhibition was with others)

35. 1957 — B (the exhibition focused on the nature)

36. 1977 — C (the exhibition includes the development of his career)

37-40 填空

37. Book A: is a great example of his shooting angle

38. Book B: all the pictures are taken outdoors

39. Book B: shows you how to use light to take pictures

40. Book C: it's about shooting approaches

例题 14

澳大利亚艺术家及其作品

填空 10

Ernabella Arts

rugs made from 31. wool/cotton

Tiwi Design

· 设计师擅长于 natural images: 32. bird (The early designs, ...were inspired by the environment and incorporated fish, bird and lizard motifs.)

· design e.g. 用于求雨 in symbol asking of 33. rain

Bima Wear

· based on symbols, structures, 34. family and nature Desert Designs: Jimmy Pike

· Jimmy Pike began his life as an design artist start in 35. prison

· Design can be used in 用于 making 36. clothing

· 艺术家 Jimmy Pike 的灵感来自于 Australia, especially the 37. desert

Bronwyn Bancroft

· Cathy Freeman's jeans 出名因为 lizards and a tailless 38. snake

· Fabric's Background look like a 39. rainbow

· 最后举例, 讲到一堆年轻夫妻 Love 命名为 “the 40. couple case” .

例题 15

Cyrus 生平

填空 10

31. legend
 32. language
 33. tax
 34. security
 35. ***
 36. administration
 37. respect
 38. reputation
 39. slaves
 40. ***

例题 16

建筑大师

单选 4+ 填空 6

31-34 单选

31. Why did she choose this topic ?

A a local building is interesting

B has interest in the experience of this architect

32. Why did the architect chose the architecture?

A under the influence of his father

B he want to do something to against the traditional style / break from convention

C he made the first wrong decision

33. Why did he come back to England ?

A *****

B he think there were more opportunities

C win more respect

34. When did he become famous ?

A after winning an international award

35-40 填空

Building Feature	Disadvantage	Now Used As
hotel	glass made windows tended to 35. <u>leak</u>	as a 36. <u>conference center</u>

Building Feature	Disadvantage	Now Used As
room has a big 37. <u>balcony</u>		open area as a 38. <u>car park</u>
1893 year was originally prison	there is no room to do 39. <u>exercise</u>	as a 40. <u>transport museum</u>

例题 17	丘纳德造船	单选 6+ 填空 4
-------	-------	------------

31-36 单选

31. Where did he get the ship experience?

A sea voyage

B family

C **first job** (when left home, he was a teenager and came to join US company, got to know sail)

32. The company experienced:

A **immediately profitable** (had an instant wealth)

B deal with one commodity (more than one cargo)

C the business world widely (major business in north America)

33. Why did him want the mail contact?

A faster

B stronger

C **more reliable** (mail contact to buy steamship brings more punctuality, other type of ships always delayed)

34. What did he do when he won the bid?

A reduced the fleet of ships

B **opened a new company** (cooperated with English, opened many branches but went bankrupt)

C appointed a new British agent

35. Why did him choose Boston?

A ***

B had a good business environment

C **once he worked here** (had first job there and built port there)

36. What could be revealed about the 1844 event?

B **Boston was not a good location for port** (one ship sank because of the winter freeze iceberg, heavy loss; then the board suggested the company move to NY, and it was a huge success, then became one of the biggest US shipping company)

37-40 填空

37. How did he improve the sail safety? by radio communication.
38. Newspaper were produced on the board, so the passengers would not feel uneasy during the journey.
39. Before 1912, paid more attention to the speed of the ships , afterwards, poured more money in the decoration.
40. afterwards, poured more money in the decoration, compared to hotels.

例题 18

科幻作家介绍

填空 6+ 单选 4

31-36 填空

31. read in magazines
32. the rocket
33. journey of planet science
34. statement position
35. the method of the micro-radiogram
36. open to public

37-40 单选

37. Which assumption doesn't come true?
A ****
B stars trek flights
C ***** transmitter
38. Why does this fail to realize ?
A material has not been discovered
39. Why **** increased ?
A extraterrestrial resource
40. What inspire him most ?
A politics
B spiritual
C science

教育研究

例题 1	儿童学习研究	填空 10
------	--------	-------

31. too much emphasize on getting a qualification
32. the government should have less influence
33. boys in particular need a new type of school
34. children in small schools a happier
35. lessons are organized like a meeting
36. university
37. college
38. parents are important in developing children's reading skills
39. conclusion is that most children are better at relationship

例题 2	戏剧对孩子的影响	填空 10
------	----------	-------

31. drama courses assist to raise the children's confidence
32. via the team work, kids can understand the importance of listening, cooperation with others
33. learn skill of taking risks : management role playing is a form of experience
34. increase the passion for participation
35. drama can have the effect of therapy
36. help students understand the morality
37. cultivate the spirit of teamwork and responsible
38. teachers can intrigue debate in a safe environment, let the students express their ideas without being scorned.
39. help children remember and understand history, react in society knowledge.
40. find the answers or solutions to problems of history why people in history made such decisions

例题 3	为学生提供实习的学校	填空 3+ 单选 4+ 填空 3
------	------------	------------------

Section 1	Section 2
company's 31. <u>mission statement</u>	maximum 33. <u>500</u> words for each skill part
student's 32. <u>CV</u> should be attached	

34-37 单选

34. Section 3 mainly talks about

- A computer literacy
 B academic qualification
 C **training session**

35. Section 4 mainly talks about

C a profile for student' s career plan

36. first class served as support

C provide the requested academic help

37. When you have problem on working surroundings, please first go to consult

A your company colleague

B tutor

C other students

38-40 简答题

38. Final deadline?

13th/30th June

39. The placement officers come to each student?

twice per month

40. General questions, other problems?

go to academic officer

例题 4	单性别学校学生的表现	单选 5+ 填空 5
------	------------	------------

31-35 单选

31. The finding is surprising because

B boys perform better

32. Girl from single sex schools tend to
A choose subjects which are often chosen by male students
33. The study is to prove whether one's socio-economical status
A has an impact on one's academic performance
34. Why did he study the single-sex schools instead of mixed ones?
A to study the behavior
35. A study carried out by Harvard university showed
B boys don't perform as well as in the past
- 36-40 填空
36. teachers should use different voice
37. girls tend to work in a group
38. boys like to read stories which are true
39. girl like to read more about the character's behavior
40. girls are more critical of their academic performance than boys

例题 5	IT 教育	填空 10
------	-------	-------

31. the use of email was not successful
Requirement of mentors
32. good relationship between mentors and students
33. mainly apply computer teaching method
34. enjoy communication with people
- Benefits of mentors
35. gain greater confidence
36. more flexible approach
37. offer now materials Benefits of students
38. develop time management skills
39. new solution to new problems
40. subsidy students' supplement of income

例题 6	计算机对教育	单选 3+ 填空 7
------	--------	------------

31-33 单选

31. what impact "digital access" bring to younger generation ?

A it alters their think patterns

B it harms their physical development

C it limits their brain capacity

32. what difference between digital immigrants and other young people?

A they use native language

B they are less efficient than the young

C they access for less important information

33. "digital accent" — digital immigrants

A their typing skill is poorer

B they often do things in an old-fashioned way

C they don't understand the instruction

34-40 分类

A Allen

B James

C Vander

34. the current thinking methods don't work — B

35. Not all students understand computer — C

36. computer technology doesn't interest all students — A

37. students can still learn in the traditional way — B

38. students still need to learn research skills — A

39. even video games can apply into teaching — B

40. computer cannot take place of traditional educator — C

例题 7

商学院课程介绍

单选 3+ 填空 7

1st year

subject: 31. engineering

work with 32. business faculty

Three textile factory

goal: the 33. printed textile

focus on 34. global market

2nd year

documentation, 35. documentation and suggestions

36. tutorials which help students make

37. reflective practice

3rd year

job opportunity of 38. journalism

4th year

there is a 39. computer aid design programme for making business plan future job of journalism in anyone interested in it, please contact us

At last there will be a short 40. interview

环境研究

例题 1	小岛生态保护	填空 10
------	--------	-------

31. We can't contrast things when birds are nesting
32. Collecting feedback from the public comments
33. The project is outstanding because the no-native animals and untouched by farming

Two Industries:

34. Develop fishing
35. Mining

Wildlife on Island:

36. Remove gas from ocean
37. Convert plants to a liquid
38. noise from ocean in Australia
39. sharks will attack when turtles are laying eggs (干扰为 crocodiles)
40. Personal pets will have impacts: especially the rats

例题 2	食物生产和消耗对全球变暖的影响	填空 10
------	-----------------	-------

31. The amount of CO2 you have to discharge from eating a meal is twice as much as that from driving.
32. The repair process of making 100g coffee can result in 140g CO2.
33. The meat production process releases more greenhouse gases.
34. A great deal of CO2 also originated from cooking.
35. The transportation is to release CO2 as well.
36. packing
37. The total amount of CO2 in creases a lot due to the damage of forests.
38. Farming practice also brings out a lot of CO2.
39. chicken's food
40. organic food, but fish is an exception

例题 3	澳大利亚轮胎回收	填空 4+ 流程图 6
------	----------	-------------

31-34 填空

- 31. the typical tire dealer may generate 600 to 800 waste tires per month
- 32. there are companies recycle rubbers for profit
- 33. recycled no limit no size of tire
- 34. 5% of the research has been completed

35-40 流程图

- 35. wheel hub to be production of steel wires
- 36. get rid of dirt segments and
- 37. The rubber can be molded with plastic for products
- 38. rubber-molded products are carpet padding or floor materials
- 39. XX is based on water and therefore environmentally friendly
- 40. MSDS: is an ink applied to the tread of a tire as a visible colour

例题 4	超市环保	填空 4+ 流程图 6
------	------	-------------

Research Methods

- 31. Interview: shoppers
- 32. website: video, but some researches on it is lack of details
- 33. interview costumers surveys of representative

	Advantages	Disadvantages
Stop A	variety of (wide range of) 34. <u>organic</u> food	too much 35. <u>packaging</u>
Stop B	bags are 36. <u>reused</u>	no 37. <u>cleaning</u> products
Stop C	people are encouraged to buy 38. <u>local</u> food/product	poor staff 39. <u>training</u>
Stop D	good 40. advertising	

例题 5

矿物质研究

填空 10

31-36 单选

31. Why did the students choose witherite mine as their topic ?

- A it's well-known locally
- B there were experts
- C it has unique importance

32. The remaining of mine now used as a

- A home
- B factory
- C office

33. the group obtain most of their materials from

- A written records
- B photographs
- C spoken stories

34. The mine first named after a

- A mineralogist
- B local doctor
- C Germany scientist

35. The mine first used commercially because

- A geological value
- B transportation factor
- C economic value

36. The mine became important because of ?

- A it can be separated from other minerals
- B location
- C easy to be processed

37-38. 多选 (五选二)

Which areas can witherite be used in ?

- A construction
- B Food industry
- C Painted materials
- D Animal and farming
- E Farming

39-40 多选 (五选二)

What are groups stuck by?

A geographical factor

B how much unexpected presence of witherite

C ***

D how quickly changes are made

E ***

龙腾教育微信号; LTJY28888

科技研究

例题 1	有机材料	填空 10
------	------	-------

31. waste
32. store
33. powder
35. starch
35. holes
36. electricity
37. agriculture
38. factories
39. business
40. demand

例题 2	未来 50 年科技发展	填空 10
------	-------------	-------

Science in the Future

Scientists are asked to predict what it will be like in technology in the next 50 years.

Computer Science

Computer Science become as significant as how to create and use 31. fire

Using the knowledge of computer has been seen as 32. intelligent

Psychology

Research on human's psychology is more 33. varied and more practical since there are more and more

34. women involved in research

We should pay more attention on 35. physical changes

Genetic

It is important to research more on the 36. gene of older people

Knowing the genome of old people can reduce the effect of 37. disease

Imaging treatment will be on 38. personal basis

Zoology

It is possible for us to see the destruction of 39. wildlife/animals in East Africa
 People need to look after the 40. planet

例题 3	利用太阳能进行水净化	填空 10
------	------------	-------

31. sea water has high level in salts so that we cannot drink such water
 32. water that is purified through solar can be used in hospitals
 33. although SW40 can purify sea water, it is too slow
 34. the promotion of such equipment got financial support from an organization called 'Health International'
 35. the maximum water can be flick in a day: 9 liters
 36. water that is purified by the machine is enough for a family

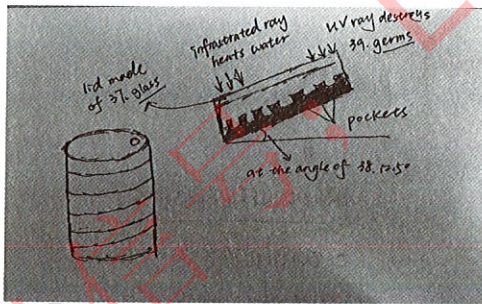

例题 4	报纸的印刷	填空 10
------	-------	-------

31 单选

31. Why this student choose this print company?

A only this company responded

B conveniently situated

C the company' s technology appeals to her

32-35 流程图

Details of Operation

1st step: take 32. negative film to plate

2nd step: air plunge

3rd step: take generated 33. image be printed

4th step: be printed by a 34. rubber blanket

5th step: printed newspaper will finally be 35. cut and 35. folded

36-40 填空

36. factory spend more time to: prevent paper jams
37. the machinery will be installed in the: air pump
38. time of installation was: 11 months
39. the huge machinery was brought in by a railway track
40. A newspaper's distribution is computerized, with a system of barcode

例题 5	塑料	填空 10
------	----	-------

31. Cellulose: get from cotton in strong acid
32. plastic is commonly found on: milk
33. the first artificial fabric is used to produce artificial silk
34. 1907, bakelite the first plastic which was made in a laboratory/lab
35. the inventor's occupant: he was a Chemist
36. bakelite is not like other plastic because it will get hard when melt in heat
37. it decomposes by light
38. it will produce gases when ...
39. One kind of chandeliers (枝形吊灯) were made up of the recycled pens
40. a Japanese cars: made by semi-synthesized materials that was found in wood

例题 6	蒸汽船	填空 6+ 单选 4
------	-----	------------

31-36 填空

31. Engineering includes building dams, bridges and roads. (轮流考)
32. Previously talked about important building? The important railway line built in the 19th century.
33. Mr. Brunel thought sail in Arctic would be impossible.
34. he chose bigger ship, because the size of engine in bigger ship would be comparatively small
35. the *** was reinforced by wood and steel
36. he built a construction company with his brother company

37-40 选择

37. what was the reaction of sailors when ship was on fire?
- A jumped into the water and survived
- B stayed on the board
- C drowned to death

38. why did the fire cause little damage?

There was a hand pump.

39. How did Great Westerner from Bristol arrived for London?

A by sailing

40. why were there many other companies also sailing across the Atlantic?

A too many passages

B beat rivals competitors

C win a good record

例题 7

有机农业发展

填空 10

31-37 填空

31. One of the advantages of organic farming is sustainable.

32. Another benefit is that it can boost sales of the products.

33. In the supermarket people can find organic vegetables such as tomatoes and potatoes.

34. In comparison with traditional product!on, organic farming product is 10% lower.

35. Without using chemicals or fertilizer, insects and weeds like attack vegetables.

36. Its environmental friendly because animals can feed on organic grass.

37. The main advantage of organic food is that it can save necessary energy.

38-40 单选

38. What happened to organic farming in India?

A yield in crease

B farming in certain area is also very successful

39. What does an international organic farming review says?

C organic farming is beneficial to wildlife

40. According to the speaker, what's the con elusion of organic farming?

A depends on consumers

社会研究

例题 1	颜色与情绪的关系	填空 10
------	----------	-------

31. In the past, the research focused on when people hearing music.
32. The maximum of study ability to handle multiple tasks.
33. Unexpected phenomenon(which is unimportant) trivial
34. evolution
35. The links are simple memories
36. We should find out the science mechanism to explain the whole thing
37. People using language, it is genetic origin; this phenomenon relates language function
38. They display (a large number of numbers of 5s and 2s)
39. In a random arrangement

例题 2	颜色与情绪的关系	填空 6+ 单选 4
------	----------	------------

31-33 摘要填空

Two kinds of people lived in the suburb either merchants or the 31. wealthy people. Advantages in living in the countryside are low tax and the 32. food prices are also low. Some people live in xxx region because it is easy to start a 33. business.

34-36 句子填空

34. building large scale housing, can meet the demand of growing population
35. mobility in roads
36. lack of space in cities

37-40 搭配

- A Suburb is less crowded than city
- B People in suburb pursue the similar goal
- C Living in the suburb is happier than in the city
- D They tend to be all the same
- E Living in the suburb is healthier than in the city
- F There are more opportunities for experimentation in the suburb

- 37. 1st person — E
- 38. 2nd person — A
- 39. 3rd person — C
- 40. 4th person — B

例题 3	measure happiness	填空 5+ 单选 3+ 多选 3
------	-------------------	------------------

31-34 填空

- A number of surveys show that 31. old people is the happiest
32. money has not much impact on happiness
- a very happy group of people. that they are more 33. sociable than others
34. negative thinking may be the cause of unhappiness

35-37 单选

35. human brains
- A are created to solve problems
- B ***
- C environment
36. describe a way people
- A want what they cant have
- B ***
- C measure happiness
37. help people to
- A discuss positive childhood experience
- B control emotion
- C set goals for the future

38-40 多选 (七选三)

- Brokers happiness charter includes
- A a healthy lifestyle
- B a fulfilling job
- C a realistic attitude to work
- D more leisure time
- E helping others
- F having fun

例题 4	从众心理	填空 5+ 单选 3+ 多选 3
------	------	------------------

31. Line in two cards, find out the lines in same length.
32. Attendants intentionally give wrong answers
33. Even intelligent people will follow others.
34. observe the lights' movement
35. Researchers develop a website for the experiment.
36. People have good reasons to the communications with others.
37. People tend to copy each other's bchawr inside the dark room.
38. express their fear of being laughed at
39. a room filled with smoke
40. People did not believe it was an emergency.

例题 5	男女在竞争下的差异	填空 5+ 单选 3+ 多选 3
------	-----------	------------------

31. The survey was done on the influence of competition in the workplace.
32. Phenomenon: only 2% women take important position in large company.
Attitude in the report for male and female is different
33. possible reasons: women are weaker in three sides: math, science and engineering
34. When Man and women's skill and are equal, they are treated unequally.
35. Women like to take less workload compared to men. Results show.
36. Men are more confident.
37. Percentage of women who are not willing (avoiding) to take risks is 34%.
38. Women don't want to take competitive feedback.
39. woman do not enjoy challenges the same as men do
40. Finally the reason that women don't want take challenges is because they worry future salary and opportunity.

例题 6	科学家分享研究成果	填空 10
------	-----------	-------

31-35 单选

31. why share research:

It is Important for progress of research modern society

32. Genetics have mixed feeling

33. put research on progress

34. 这项调查的调查对象 (what respondents) are in this research/survey:

A staffs working in academic institutions

B 有着学位 diploma 但是不是在大学里面 (校外) 工作的人

C 大学教授们推荐的 those who are recommended by the professors

35. what do scientists usually concern with and discuss?

B. how to share information

36-40 分类

A Some 情况下 (the most scientist) will share 自己的科研成果

B Less 情况下只是一些科学家愿意 share 自己的科研成果

C Most 情况下科学家 are not willing to share 自己的科研成果

36. B (36%的科学家会 tend to share, 所以应该选, 某些情况下, 科学家愿意 share)

37. A (说借鉴别的科学家的 idea)

38. C (有些人以为因为与公司的利益有 conflict (93% reported that their institution had a formal policy that required researchers to file an invention disclosure before seeking to commercialize research results, 所以科学家不愿意分享科学成果, 实际上只有 15%的科学家会这么认为, 所以是大多数科学家愿意 share)

39. A

40. C (share 的话更容易得到将来的经费 fund)

健康研究

例题 1	听觉丧失和修复	填空 10
------	---------	-------

31. function
32. trumpet
33. receiver
34. magnet
35. conversation
36. telephone
37. directions
38. instruments
39. training
40. technology

例题 2	医院改造花园	填空 10
------	--------	-------

31. infection
32. As for the patients, it would be better to look at the scenery than looking at the wall.
33. electronic activity: heart
34. easily moved: wheelchair
35. relaxation
36. The facilities in the garden contain a fountain and others.
37. immune
38. The facilities in the garden could attract birds.
39. hospitals are a source of stress
40. society

例题 3	埃及的医药	填空 10
------	-------	-------

31. recordings only organized into lists

- 32. imported
- 33. sculptures
- 34. flavor
- 35. minerals
- 36. fish just as symbols of power
- 37. sugar
- 38. clean
- 39. materials such as resin and metal trapped the mummy
- 40. honey can be used to heal wounds

例题 4	熏烟消毒法 fumigation	填空 10
------	------------------	-------

31. using chemicals may affect ozone layer

COMMON FUMIGANTS: (methyl bromide)

- reduce the 32. color of painting
- Bromomethane was also used as a general — purpose fumigant to kill a variety of pests including rats and insects.
- protect food and being kept in a sealed 33. bag (Food and medicinals are not sealed can be removed or placed in polyethylene bags and closed with tape.)

TIME AND SETTINGS:

- applied in more humid countries will be more 34. expensive
- longest exposure time will be 35. 14 days
- sealed environment with 36. nitrogen create a perfect seal and a pump which extracts oxygen and introduces an atmosphere of - or CO2
- a scientist successfully preserved 37. a wooden/wood sculpture
- chemical from some skins of 38. frogs
- like nature occurring 39. pesticide to kill the bacteria
- not effective in 40. moisture

例题 5	夜班对健康的影响	填空 10
------	----------	-------

- 31. huge increase (上夜班的人数变多)
- 32. internal clock
- 33. light dark

34. unsocial hours
 35. heart/ stomach
 36. depression
 37. mental abilities
 38. performance
 39. family life
 40. peer group/ friends

例题 6

新西兰儿童健康情况

填空 3 + 单选 4+ 填空 3

31-33 填空

31. survey from health department and University
 32. food allergies and food intakes
 33. eating pattern sample dietary: physical activity

34-37 单选

34. How this survey choose the school, the respondents are
 A a random sample
 35. How do they finish the test for the result
 B at home
 36. compared with old children, young children were
 A more exercises than the older
 37. old children are
 A more easily to be influenced by their peers

38-40 填空

38. Some European kids are lack of vitamin A
 39. Pacific (Mario) children eat more fish than European children
 40. Government schools encouraged giving more exercises

例题 7

古罗马香料

填空 10

31. Romans use spices to produce perfumes
 32. pepper was a display of wealth/fortune
 33. contributed to exploration of the New World
 34. change a person's mood

spice B — clove	can reduce/relieve the pain of 35. <u>tooth</u>
peppercorn	can take the place of 36. <u>money</u>
spice C — burnt scent	hide the domestic 37. <u>smell</u>

38. most expensive because : transport costs
 39. promoted development of ship-building industry
 40. brought in valuable income

例题 8	古代食物	填空 10
------	------	-------

31. Diet was influenced by geographical and social factors
 32. 未消化的食物在 stomach
 33. food sticking to pots
 34. prepared and eaten food
 35. knife used for cooking
 36. the amount of food people lent to consume
 37. chemical signature
 38. teeth that showed some values
 39. common that failed to survive
 40. extreme climate

例题 9	商品盐	填空 10
------	-----	-------

31. salt is essential for human's health
 32. origin for English word salary derived from the Latin word used to described the payment made to Roman soldiers
 Sweden
 33. animals are fed in the local, surrounding forests during the summer
 34. the fresh meat is available in October only
 35. record (1573) has been used widely: we can tell from the diet of king of Sweden
 36. beer consumption is large because the food was so salty
 37. sweden needs to protect its shipping to import commodity salt
Sources
 38. from basins in desert locations, Sahara warm climate

39. salt from spring water is more concentrated and pure

Compared to sea water

40. salt trade cities formed due to a nature mean of transport

例题 10

食品安全

填空 10

31. ingredients

32. stored

33. temperature

34. organic

35. image

36. information

37. prime motivation

38. entertainment

39. cooking

40. parents

商业研究

例题 1	专利代理人 patent attorney	填空 10
------	-----------------------	-------

31. employed mostly by a company

Job Focus

32. originality must be claimed

33. details in products description

34. knowledge in engineering

35. good communication skills

36. mastery of foreign language

Advantages

37. offered a good salary

Disadvantages

38. sometimes quite lonely

Co-operation with

39. industrial organizations

40. government offices department

例题 2	员工培训方法	填空 10
------	--------	-------

31. develop by army

32. a safety incident

33. need trust

34. keep a focus on strategies for interactive learning

35. need to check results and reasons

36. leaders

37. use open questions

38. get member ideas in writing

39. provide training to employees

40. check the time often

例题 3

open-style office 利弊

填空 10

31. typing
32. desks
33. screen
34. share
35. security
36. space
37. health
38. noise
39. training
40. energy

例题 4

连锁店改革

填空 10

31. The government should open more branches of petrol station to increase its market share in England.
32. They should reduce the number of such branches in Southern Scotland.
33. Another solution is to close the head office in London and Oxford.
34. A new brand is focused on fresh food.
35. Over 200 staffs have to be retrained and transferred.
36. They had a contract manager to handle the discussion.
37. Retail stores should be flexible in profits.
38. An open mind in strategies is needed for company expansion.
39. People can seek for help from their partners.
40. They can save cost by changing organization in the department store.

植物研究

例题 1	棉花种植	填空 10
------	------	-------

31. 种植的 process 浪费了大量水
32. 杀虫剂的好处节省劳动力和 machine
33. 人不会使用杀虫剂, 没有 protective clothing
34. 问题 irrigation
35. 灵感来自 freedom
36. 需要 energy 生产
37. 灵感来自 nature
38. 灌溉方法 rainwater
39. 回收衣服为 sports
40. 其他的生产设备 cleaning machine

例题 2	松树研究	填空 10
------	------	-------

31-34 单选

31. Why does the woman want to choose the pin trees as research object

A long history

B ***

C reflect the science

32. What happened to the pine trees there?

A wrong place

B harmful to habitants

C colder than settlement...survival

33. pine trees can be used as torch

A cannot fire for a long time

B too much smoke

C dim light

34. Pine trees used for making ropes

A high quality

B dry

C flexible

35-40 填空

Name of Garden	Feature	Function
35. <u>water pipes</u>	***	36. <u>chewing gum</u>
***	***	37. <u>medicines</u>
***	***	38. oil used in <u>bathroom</u>
39. <u>South</u>	40. <u>native</u> plant	***

例题 3

入侵植物

填空 10

Invasive species can take over a 31. garden

The phenomenon is mainly caused by 32. humans/ people

Common Broom

is originally from 33. Europe

has a major impact on 34. timber industry

Biological measures to control is to use 35. insects

Japanese Berries

is originated from 36. Russia

yellow 37. tissues

grow in 38. pairs called ultimate leaves

impact the diet and 39. migration pattern

can be used to cure 40. digestive/ digested disease

例题 4

新西兰紫雏菊

填空 10

Echinacea in New Zealand

· Benefit

- improve your 31. immune system

- prevent people from 32. flu

- be effective particularly for 33. children

- History
 - the 34. flowers of the Echinacea are used by North American
- Experiments done by Scientists B and H
 - Found that Echinacea grew faster in specific area, due to
 - 35. climate of the area
 - 36. sand in the soil
- Future crop plan
 - 37. irrigation system
 - destroy 38. weeds
 - dry 39. roots of dead plants
- Future business plan
 - reduce the price for overseas
 - use the bottle with sign on to show it's 40. organic

建筑研究

例题 1	法国南部古堡	填空 10
------	--------	-------

31. Roman trading giants of XX's findings: pottery
 32. 1500s, a French found the remain of castle
 33. British archeologists and Swedish conducted a full survey

建筑名字	位置	备注
local 34. <u>market</u>	***	35. <u>silver coins</u>
C*** (building)	Eastern region	evidence for 36. <u>textile industry</u>
Dowye house	***	people come to collect 37. <u>water</u>
Ancient Theatre	Northeast region	face next to the stone 38. <u>bridge</u> on the river
***	Southeastern	the sculptures of 39. <u>lions</u>
Roman Bath	35. <u>centre area</u>	another sculpture is for 40. <u>Emperor</u>

例题 2	各国学校的新建筑	填空 10
------	----------	-------

Building Design

new approach: build school as a center of learning, not as a 31. factory

Indian Mountain School

main structure made of 32. wood with both traditional and modern style

special feature: provide good 33. view in the classrooms

Northland School

unwelcoming section of the building has few visiting

the attitude of the construction is to be 34. flexible

special feature: 35. social educational need of the student.

Denmark school

a "homebase" with a 36. kitchen and place for studying.

compared it to a 37. village than a school

school in England

maximize the 38. light

the roof has 39. grass on it, help to collect energy from the roof

collect the 40. water for recycle use

例题 3

澳洲火车线路建设

填空 6+ 单选 4

31-36 填空

31. 在建设初期遇见的困难 economic and logistical problems

32. the building been assisted by camel

33. closed down in 1976

34. 'Never Never Line' is called gap

35. 很多人认为 the line to nowhere could not make a profit

36. the rail construction was affected by the climate

37-40 单选

37. air travel (compared to rail) can offer

C enjoy sceneries

38. the new railway system's disadvantages

A infrequent trains and not enough passengers

39. Darwin as port can be

B well located for international trade

40. the problem of railway transport

C loss of goods during transporting

例题 4

伦敦的房屋

填空 6+ 搭配 4

31-35 填空

31. there has been a low impact on environment

32. it is energy-saving because of the alternative energy technologies

33. conservation of land resources

34. go underground, there is no traffic noise outside

35. the construction can have a long lifespan

36. the healthy benefit comes from the methods of..

37-40 搭配

(two new houses type shortened in M and H)

A M

B H

C Both M and H

37. saving energy — C38. zero noisy — B39. low cost — B40. durable contracture — A

例题 5

城市发展

填空 10

31. negative beliefs: more noise in cities
32. new way to bring water into home
33. new source of power including electricity
34. cities have higher wages
35. *** now have fewer children
36. a city of 8 million people needs less infrastructure than a city of 4 million
37. cities less impact on environment
38. people in large cities now have fewer children
39. history influences whether a city gets richer while gets bigger
40. difficult to keep a balance between growth and population

龙腾教育微信号; LTJY28888

龙腾教育微信号：LTJY28888

龙腾教育微信号; LTJY28888

龙腾教育微信号; LTJY28888



扫码关注微信公众号“考虫烤鸭”
干货、经验贴、海外文化俯拾即是



扫码关注官方微博@考虫雅思
课程上线、抽奖等信息精彩纷呈